

Richard & Sarah Fowler
of
Columbus County, North Carolina,
Monroe, Clarke, Wilcox, & Dallas Counties, Alabama,
& Union Parish, Louisiana

By Timothy Dean Hudson
2021



Contents

1. Biographies of Richard and Sarah Fowler3

2. Fowler Farms in Alabama and Louisiana7

3. Abstracts of Records of Richard and Sarah Fowler12

4. The Richard & Sarah Fowler Family Bible21

5. Richard & Sarah Fowler’s Children23

6. Known Grandchildren and Great-grandchildren of Richard & Sarah27

7. Notes48

♦ ♦ ♦ ♦ ♦ ♦

Biographies of Richard and Sarah Fowler

Richard Fowler was born on 17 January 1792 in Prince George's Parish, Georgetown District South Carolina, the son of John Fowler (1747–1845) and Elizabeth Rackley (1760s–1815/1825). His parents' families had lived in the Sampson/Duplin region prior to Richard's birth. His father had served in the North Carolina militia, fighting for the Patriot side during the American Revolution. In fact, on 27 February 1776, John Fowler saw action at the Battle of Widow Moore's Creek Bridge, where the Patriots routed the Tory army and helped advance the patriot cause throughout the Colony of North Carolina. Fowler moved across the state line into South Carolina sometime in the 1780s, before Richard's birth. He remained there until shortly after 1800, when he returned to North Carolina and settled in Columbus County. Based upon the date of his eldest known child, Richard Fowler married sometime prior to mid-1812 to Sarah, born on 3 May 1790 in North Carolina [1].

On 27 July 1812, shortly after his marriage, Richard Fowler enlisted as a private in the company commanded by Captain Caleb Stevens, in Major John A. Lillington's detachment of North Carolina militia during the War of 1812. His unit was stationed at Deepwater Point, North Carolina and his commanders listed him as present for duty during his six-month tour of duty. He received payment of \$6.66 per month until his discharge on 23 December 1812 [2].

The birth of Richard Fowler's eldest daughter Elizabeth occurred on 2 February 1813, not quite six weeks after his discharge from the North Carolina militia. Thus, we presume that his marriage to Sarah occurred prior to his enlistment in the militia the previous July. We only have evidence that Richard married once. Family tradition related during the twentieth century by a variety of Fowler descendants living in Union Parish, Louisiana insists that Richard's wife was "*Sarah Paramore*." No evidence to support this claim has yet been found [3].

Richard and Sarah lived in Columbus County North Carolina for about five years after their marriage. During this time, they lived on a farm located on the south side of Beaver Dam Swamp that adjoined the farm of his father, John Fowler, as well as those of John Wilson, William Sikes, and Duncan Sikes. It is not clear if Richard owned or rented this farm, for many land transactions of that era went unrecorded. By 1818, after about six years of marriage Richard and Sarah had four daughters: Elizabeth, Elvira, Phiney/Sheny, and Milly Fowler [4].

In 1818 or 1819, Richard and Sarah moved their family from North Carolina to Alabama Territory, first settling in Monroe County. Their fifth daughter, Samantha Fowler, was born there on 19 November 1819 [5]. On 21 October 1821, Richard purchased 80 acres of government land in what is now Clarke County, Alabama for \$100.12½ in cash. Fowler paid for the land with \$80 from his account in the bank at Darien, Georgia, \$20 from his account with the Planter's Bank in Georgia, and 12½ cents in change [6]. It is not clear whether Fowler ever moved onto his new farm, for when he made his second purchase of government land on 19 November 1827, the land officer still listed Fowler's residence as Monroe, not Clarke, County. On the other hand, perhaps his proximity to the Monroe/Clarke County line made these geographical designations fluid during these early years of Alabama statehood [7].

During the winter of 1827–1828, nearly ten years after their arrival in Alabama, Richard and Sarah Fowler decided to leave their neighborhood and move about thirty miles northeast. For their new home, they chose a location near the Village of Snow Hill and the point at which Wilcox-Dallas-Lowndes Counties intersect. On 19 November 1827, Richard Fowler purchased 80 acres of government land a few miles northwest of Snow Hill, lying on the Dallas County side of the Dallas/Wilcox county line. His neighbor on the east side of his new farm, Martin Batte Lee, presumably sold an additional 80 acres to Fowler over the next few years. Then on 16 May 1831, Fowler made his third and final

government land purchase, obtaining 71.5 acres of land that adjoined his existing farm, this time on the Wilcox County side of the county line. The Fowler's farm now consisted of 231.5 acres bisected by the Dallas/Wilcox County line [8]. After only a few years, Richard and Sarah decided to move again, although this time they remained in the Snow Hill vicinity. On 17 January 1833, they sold their farm to Henry McCoghren for \$800, what appears to have been a rather substantial profit [9].

In about 1832 or 1833, Richard and Sarah bought a new farm located roughly two miles to the west/southwest of their former one, still near the Dallas/Wilcox county line but this one entirely on the Wilcox County side of the line. They obtained 141.8 acres of their new farm from William Drake, who bought it in October 1833 from Enoch Albritton, a man whose son later married Richard and Sarah's daughters Milly and Sarah Ann, and whose grandson married their youngest daughter, Susannah. The new Fowler farm also adjoined that of Addison Scarborough, whose son married another Fowler daughter within a few years [10]. Fowler made additional purchases of land in the mid-1830s, increasing his acreage to a total of 212.7 acres. His new farm was located just about ½-mile from Snow Hill [11]. In the early 1840s, Richard and Sarah began accumulating another farm nearby, just about two miles due south of their existing farm and adjoining the Bethsaida Baptist Church. Their motivation for purchasing this additional farm remains unclear, but it appears that their main farm remained the one located closer to the county line [12].

Like most Southerners, Richard Fowler farmed for a living. The records suggest he managed to earn a good living and supported his family well, even though he had seven daughters and only one son. Fowler primarily relied on himself for his farming pursuits, as he did not own many slaves. He owned no slaves in 1830, but by 1840, he had three slaves living in his household: a female aged between 36 and 55 and two male slaves aged between 10 and 24 years of age. That year, five members of the household were engaged in agriculture, presumably Fowler and his son, plus the three slaves [13]. By 1854, Fowler owned two male slaves, presumably the same two he owned in 1840 [14]. We have no indication of how Fowler obtained his three slaves. On 3 February 1855, he purchased one slave at an estate sale. Fowler paid \$1100 for "*the negro slave Prince, about forty five years of age black color, and a slave for life...*" We have no record of what became of Prince or the other Fowler slaves after the deaths of Richard and Sarah Fowler a few years later [15].

The unfortunate lack of available records prevents us from definitively knowing Richard and Sarah Fowler's religious affiliation. However, a preponderance of circumstantial evidence points to their following the Primitive Baptist faith. Only a few years after the Fowlers arrived in Snow Hill, the Bethsaida Baptist Church formed at Snow Hill. Although the original church minutes apparently do not exist, a church history written in the mid-1900s states that it formed in 1831. Bethsaida Baptist Church applied for membership in the Bethlehem Baptist Association at its 1831 associational meeting held at Fellowship Church in Wilcox County from September 24th until 27th. She then had seventeen members but no preacher. By 1832, J. A. Butler served as pastor of Bethsaida, and in 1834 and 1835, Thomas Trowell served as the minister. The church's membership held at nineteen between 1832 and 1834, then increased to twenty for 1835–1836. Elder Robert Warren represented Bethsaida Baptist Church at the Bethlehem Associational Meeting beginning 24 September 1836. Along with other anti-mission churches, Bethsaida applied for letters of dismissal from the association at this meeting [16]. Although we have no documentation that Richard and Sarah belonged to Bethsaida Baptist Church, their Snow Hill farms adjoined those of Martin B. Lee and Addison Scarborough, both active members of Bethsaida Church. Moreover, after the Fowlers moved to Louisiana in the 1850s, their farm adjoined that of James D. Griffin, the son of a Bethsaida Church deacon [17]. Another indication that Richard

and Sarah belonged to Bethsaida Baptist Church is their purchase of their second farm near Snow Hill in the early 1840s: this property adjoined Bethsaida Church. In addition, many of their children and grandchildren belonged to the Liberty Hill Primitive Baptist Church in Union Parish, Louisiana, located just about 1.5 miles from the farm Richard Fowler bought in Union Parish, Louisiana in 1851.

In an era in which many adult males remained illiterate, Richard Fowler received at least a rudimentary education as a child growing up in rural northeastern South Carolina and southeastern North Carolina. Throughout his adult life, he signed his name to land transactions. Two known samples of Fowler's original signature exist, including this one at age forty-six

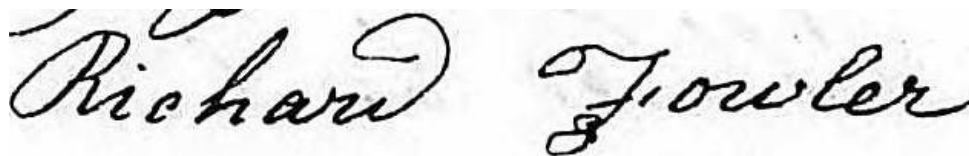
A handwritten signature in cursive script that reads "Richard Fowler". The ink is dark and the handwriting is fluid and legible.

The sample on the front page shows Fowler's signature at age sixty. His clear, distinctive, and beautiful signature is indicative of a man accustomed to writing and signing his name. Sarah Fowler, on the other hand, was illiterate and made her mark to land transactions [18].

Although Richard Fowler's parents clearly made certain he received an education, Richard did not do the same for his daughters. Like many nineteenth century Southerners, he may have ensured the literacy of his son but not that of his daughters. At least three of Richard and Sarah's daughters remained illiterate throughout their adult lives: Elvira, Samantha, and Sarah Ann. Like their mother, all three resorted to making their marks to legal transactions during their lifetimes [19]. Richard and Sarah's youngest daughter, Susannah Fowler, was born in 1827 and grew up in Snow Hill. In 1899, Susan stated that "...I went to school... when I was twelve years old," which would have been in 1839 or 1840. There is some evidence that the Snow Hill community schools were founded in the latter 1830s, so she may have been the only Fowler daughter still of school age by the time local schools formally organized. Like her father, Susan had a distinctive handwriting when she signed her name at the age of seventy-two [20].

In 1845, a severe drought plagued portions of central Alabama and Georgia, causing widespread crop failures. According to one Georgia resident writing in 1847,

...We have the hardest times in this country that we ever have had since we have lived here. Corn cannot be bought for a dollar a bushel. The folks are going from here to Arkansas a good many of them...We have had the hardest times now that I ever have seen in my life. There is no corn in Georgia nor much of anything else to eat or feed with... [21]

To escape these conditions, many people left Georgia and Alabama for the cheap government land available in Mississippi, Louisiana, and Arkansas. It is believed that these conditions prompted several of Richard and Sarah's children and long-time neighbors to emigrate from their homes in the Snow Hill community to the Bayou d'Loutre region east of Farmerville, in Union Parish, Louisiana. Their daughter Samantha Fowler Scarborough and son-in-law George Washington Albritton, as well as neighbor Martin B. Lee, all left Snow Hill and moved to Louisiana in 1847 [22]. Records indicate that Albritton's wife, Milly Fowler, died about 1846–1847, and her sons, Enoch Richard and James Andrew Albritton, remained in Snow Hill with their grandparents while their father went with relatives to establish new farms in Louisiana [23].

Richard and Sarah Fowler remained on their Snow Hill farms through the 1850 growing season, and in 1850, Richard Fowler's household as enumerated on the Alabama State Census consisted of:

2 white males over 21	2 white females under 21	4 slaves
1 white male between 18 and 45	3 white females over 21	11 total inhabitants
1 white male over 45		

We can only speculate as to the precise identities of the Fowler household, but the only unmarried Fowler child was Richard and Sarah's youngest daughter, Susan, then aged twenty-three years. Presumably, the younger male and one of the females were Richard and Sarah's only son, Richard Walter Fowler, and his wife, Laura. One of the younger females could have been an infant daughter of the latter couple, while the other was likely one of Richard and Sarah's Robinson granddaughters, the daughter of Elvira Fowler Robinson Polk [24].

On 13 November 1850, Richard and Sarah Fowler sold their two farms totaling 360 acres for the sum of \$1000 [25]. It appears that immediately after this transaction, they left Snow Hill, for when the U.S. Federal Census enumerator visited Snow Hill, he did not list them as residents [26]. The Fowler's eldest surviving daughter, Elvira Fowler Polk, remained in Alabama until early December, but that winter the Fowlers and Elvira and her family all followed Samantha Fowler Scarborough and Sarah Ann Fowler Albritton to Union Parish, Louisiana. The records indicate that they had arrived there by March 1851 [27].

On 17 October 1851, Richard Fowler purchased a 237.39-acre farm a few miles southeast of the farms of his daughters Sarah Ann and Samantha. He paid \$600 cash and gave two promissory notes for \$300 each due in January 1853 and January 1854 as payment [28]. A year later, Fowler's son-in-law, Noah Scarborough, sold his farm a few miles away and purchased vacant government that adjoined Fowler's; Scarborough increased his holdings over the next few years until his farm reached 440 acres [29].

On 25 August 1852, Richard Fowler appeared before Justice of the Peace Thomas Van Hook to apply for Bounty Land based upon his military service during the War of 1812. Fowler made the following statement regarding his military service [30]:

Richard Fowler aged Sixty years, a resident of the Parish of Union State of Louisiana...declared that he is the identical Richard Fowler who was a private in the Company commanded by Captain Caleb Stevens in the Battalion Commanded by Major Lindsey, North Carolina Volunteers (name of Colonel commanding Regiment forgotten) in the War of 1812 with Great Britain. That he enlisted at Whitesville in the State of North Carolina on or about the last of May or first of June 1812 (exact date forgotten) for the term of six months, and continued in actual service in said War for the term of six months or about that term, and was honorably discharged at Wilmington, North Carolina on or about the 20th December A.D. 1812, but received no certificate of discharge, from some cause not known to him.

On 3 February 1855, Richard Fowler attended the sale of the Estate of Henry R. Bryan in front of the courthouse in Farmerville. Fowler purchased Prince, the slave referenced earlier, for \$1100 [31]. This is the last known record of Richard Fowler.

On 3 December 1857, Richard Fowler's son-in-law, George W. Albritton, bought his final 40-acre tract of government adjoining his original Union Parish farm located about three miles north of the Fowler/Scarborough farms [32]. A few weeks later, on 3 January 1858, another Fowler son-in-law, James R. Albritton, husband of Susan Fowler Albritton, purchased the farm of former Snow Hill resident James D. Griffin, which adjoined both the Fowler and Scarborough farms [33]. Sometime during the year 1858, George W. Albritton sold his original Union Parish farm and assumed ownership of Richard Fowler's farm; George Albritton owned it by 7 February 1859 [34]. At this point, the three Fowler sisters Samantha, Sarah Ann, and Susan all resided on adjoining farms, along with their mother, Sarah Fowler (Elvira and her family left Union Parish and moved further west into De Soto Parish by the mid-1850s).

It appears that Richard Fowler died in the year 1858, prompting George W. Albritton to sell his farm and acquire the Fowler farm that adjoined those of his wife's sisters, Samantha Scarborough and Susan Albritton. Sarah Fowler died on 6 November 1859 after suffering with pneumonia for one week [35].

♦ ♦ ♦ ♦ ♦ ♦

Fowler's Farms in North Carolina, Alabama, and Louisiana

Like the vast majority of antebellum Southerners, Richard Fowler farmed for a living. With seven daughters and only one son, he had little help from his family with his agrarian pursuits. Fowler farmed in Columbus County North Carolina between about 1814 and 1818, but no records exist to prove he actually owned his land there; he may have rented it. His North Carolina farm adjoined that of his father, John Fowler.

In 1818, Richard and Sarah Fowler joined the influx of white settlers into the former Creek Nation heartland (now modern central Alabama) seized by General Andrew Jackson following his defeat of the Red Sticks (the anti-American faction of the Creek Nation) at the Battle of Horseshoe Bend in 1814. The Fowlers first settled in what was then Monroe County, Alabama Territory. Richard purchased 80 acres of government land there in October 1821. His property technically lay in Clarke County, but very near the Alabama River which formed the county line between Clarke and Monroe Counties. It is unclear whether the Fowlers ever settled on the land he purchased in 1821, and we do not know when he disposed of that land.

Richard Fowler did remain a resident of Monroe County through November 1827, when he purchased government land about thirty miles northeast of his Clarke County property, in southern Dallas County near the Dallas/Wilcox county line and the village of Snow Hill. He farmed in that vicinity until November 1850, when he followed his married daughters to Louisiana. Richard Fowler purchased a farm in Union Parish, Louisiana in 1851 and operated it until his death in 1858.

The tables below show the legal descriptions of the land that Richard Fowler and his sons-in-law possessed during his lifetime, and the schematics show the relative location of Fowler's farms to that of his sons-in-law and closest known associates.

Richard Fowler's Alabama Farms 1827-1850					
Date bought	Description	S-T-R	Acres	County	Date Sold
19 Oct 1821	W½ of NE¼	S20 T8 R5	80.1	Clarke	unknown
19 Nov 1827	E½ of SW¼	S31 T13 R11	80.05	Dallas	17 Jan 1833
unknown	W½ of SW¼		80.05		
16 May 1831	E½ of NW¼	S6 T12 R11	71.5	Wilcox	13 Nov 1850
1831-1837	SW¼	S4 T12 R11	212.7		
1834-1837	SW¼ of NW¼				
	SE½ of NW¼				
24 Nov 1840	SE¼ of SE¼	S17 T12 R11	30		
16 May 1843	NE¼ of SE¼		40		
22 Aug 1844	NW¼ of SW¼	S16 T12 R11	38.5		
1845-1850	SW¼ of SW¼		38.5		

The Snow Hill Area of Dallas-Wilcox Counties Alabama
1827-1850

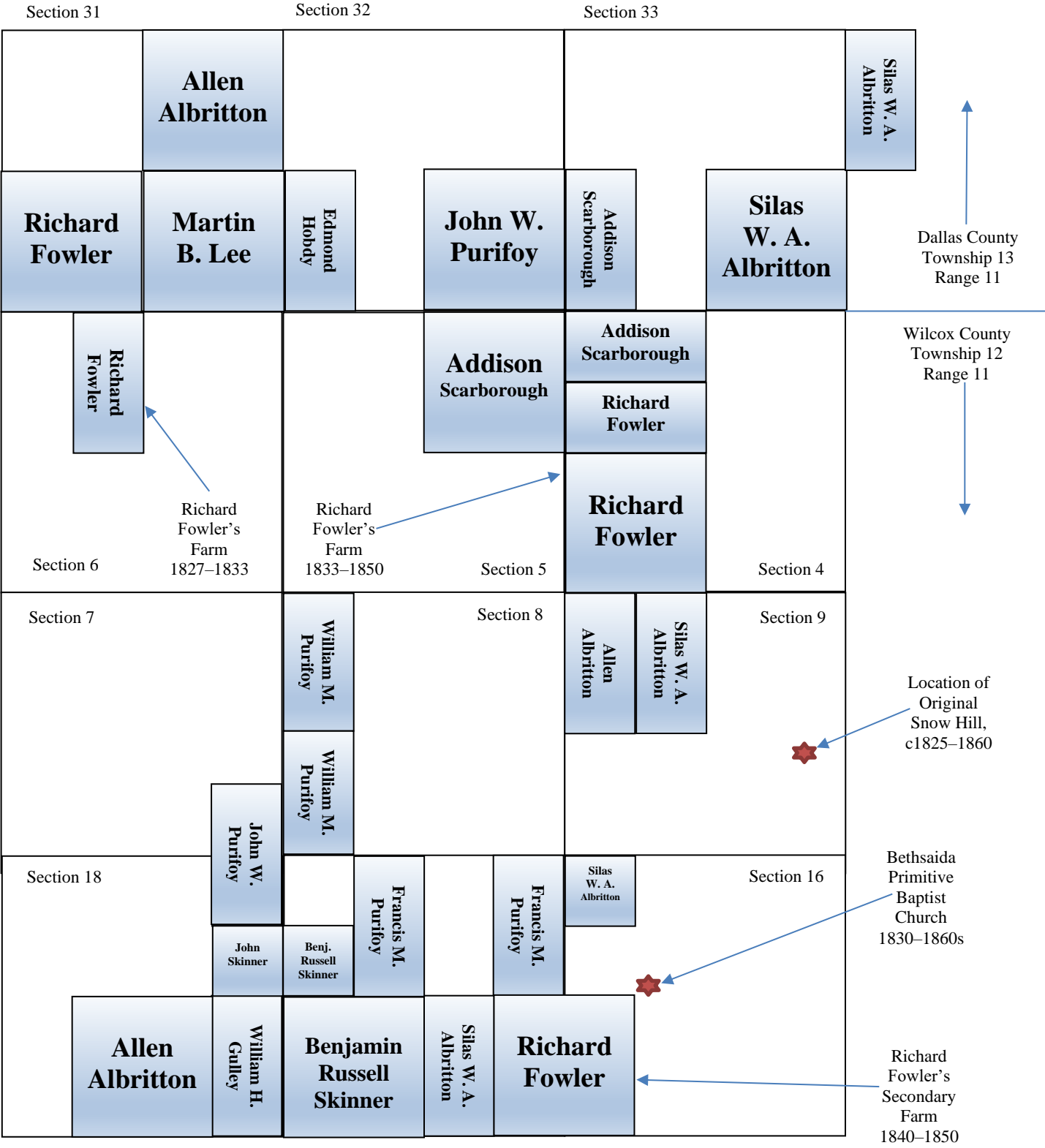

Union Parish, Louisiana Farms of Richard Fowler & his sons-in-law 1851-1868					
Date bought	Owner	Description	S-T-R	Acres	Date Sold
22 Feb 1848	Noah Scarborough	NW¼ of SW¼	S4 T21N R1E	39.95	2 Nov 1852
c1848	George W. Albritton	SE¼ of SE¼	S2 T21N R1E	40	
12 July 1849		SW¼ of SE¼	S2 T21N R1E	40.39	
12 Aug 1851		N½ of SE¼		120.72	
		NW¼ of SE¼	S1 T21N R1E		
13 Oct 1851		SW¼ of NW¼		39.94	
3 Dec 1857		NE¼ of SW¼		39.94	
17 Oct 1851	Richard Fowler	SW¼ of NW¼	S17 T21N R2E	40	pre-1859
		NE¼ & NE¼ of SE¼	S18 T21N R2E	200	
15 Jan 1852	Wiley J. Polk	NW¼	S32 T22N R1E	160	8 Nov 1852
22 Nov 1852	Noah Scarborough	SW¼ of SW¼	S17 T21N R2E	40	18 July 1901
15 Nov 1854		NE¼ of NE¼	S19 T21N R2E	40	
		NW¼ of NW¼	S20 T21N R2E	40	
10 Oct 1857		SE¼ of SE¼	S18 T21N R2E	40	
3 Dec 1857		SE¼ of NE¼	S19 T21N R2E	40	
		SW¼ of NE¼ & SE¼ of NW¼	S19 T21N R2E	80	
27 Oct 1859		SW¼ of SE¼	S18 T21N R2E	79.1	
		NW¼ of NE¼	S19 T21N R2E		
		NW¼ of SE¼	S18 T21N R2E	39.44	25 Jan 1884
4 Dec 1854	James R. Albritton	SE¼ of SW¼	S4 T21N R1E	40	1 Jan 1858
		NE¼ of NW¼	S9 T21N R1E	40	
3 Jan 1858		SW¼ of SW¼ & N½ of SW¼	S18 T21N R2E	120	6 Dec 1866
		NE¼ of SE¼	S13 T21N R1E	40	
7 Feb 1859		SE¼ of SW¼	S18 T21N R2E	39.44	
24 Oct 1859		NE¼ of NW¼	S19 T21N R2E	40	
unknown	George W. Albritton	NE¼ of SW¼ & NE¼ of SE¼	S18 T21N R2E	80	
		SW¼ of NW¼	S17 T21N R2E	40	
7 Feb 1859		N½ of SW¼	S17 T21N R2E	200.93	
		NW¼ of SE¼			
		S½ of NE¼			
14 Oct 1862			SW¼ of SW¼	S8 T21N R2E	40

**Richard Fowler & Noah Scarborough
Union Parish, Louisiana Farms
1851-1857**

Richard and Sarah Fowler followed their married daughters Samantha Scarborough and Sarah Ann Albritton to Union Parish, Louisiana during the winter of 1850-1851. Richard purchased a 240-acre farm there in October 1851. At that time, both Samantha and Sarah Ann lived on farms a few miles away. In 1852, Noah Scarborough sold his existing farm and began purchasing vacant government land that adjoined the Fowler farm. By 1859, Scarborough had amassed a farm of 400 acres.

The schematic below shows the exact location of the adjoining Fowler-Scarborough farms during this period. This region lies about seven miles east of Farmerville, off the Ward’s Chapel Road. Bayou d’Loutre makes a dip into the top portion of Section 17 in the diagram below.

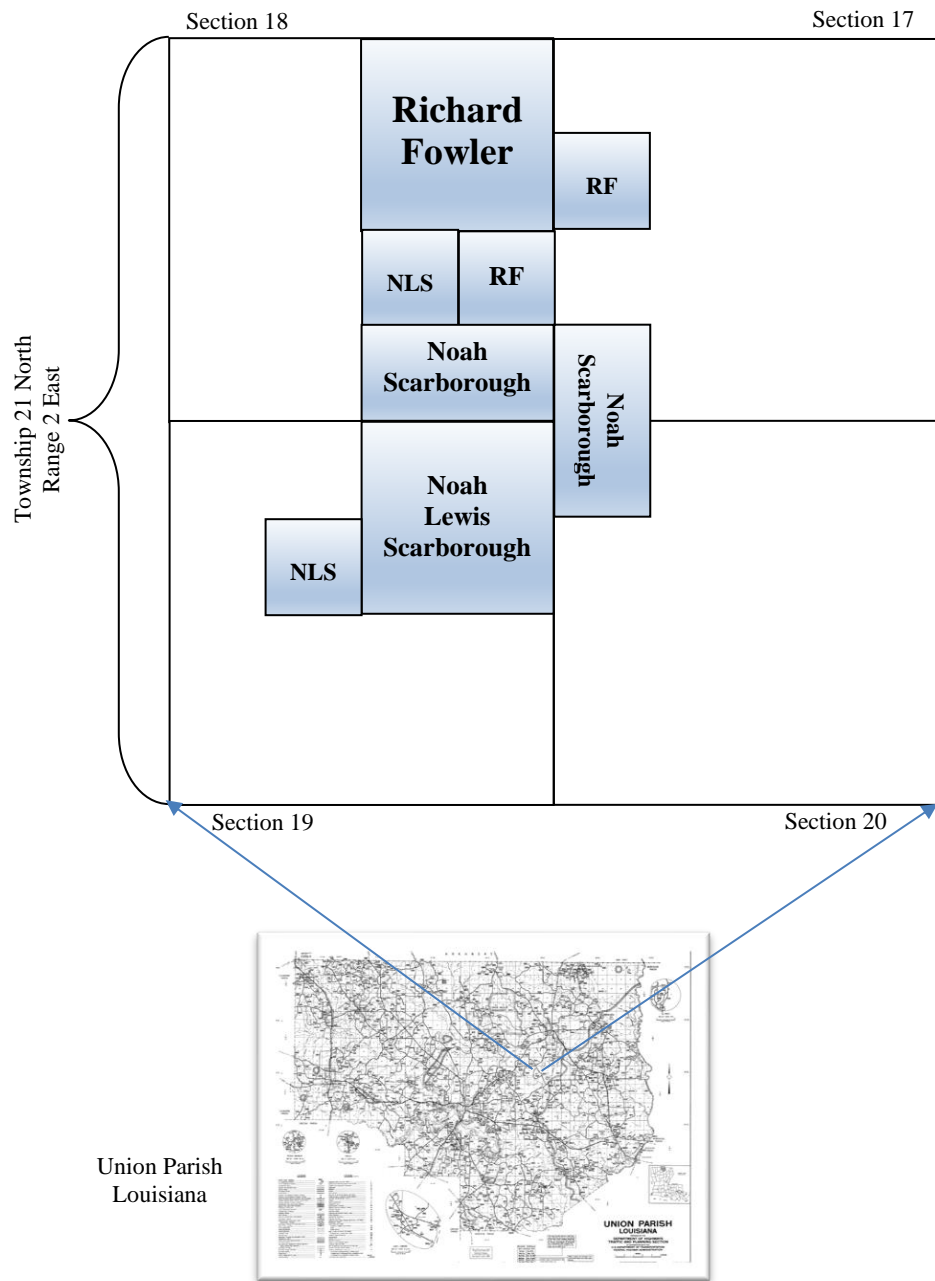

**Farms of the Fowler Sisters:
Samantha Scarborough, Sarah Ann Albritton, & Susannah Albritton
Union Parish, Louisiana
1858-1900**

In 1851, the youngest Fowler daughter, Susannah, had married James Rountree Albritton, nephew of her sisters' husband, George Washington Albritton. In January 1858, James R. Albritton purchased the farm of James D. Griffin, son of Snow Hill resident and Bethsaida Primitive Baptist Church deacon, James Griffin. The Griffin farm adjoined both Richard Fowler's old farm, now owned by George W. Albritton, and Noah Scarborough's farms. So between 1858 and 1866, the three Fowler sisters Susan Albritton, Samantha Scarborough, and Sarah Ann Albritton all lived on adjoining farms several miles east of Farmerville.

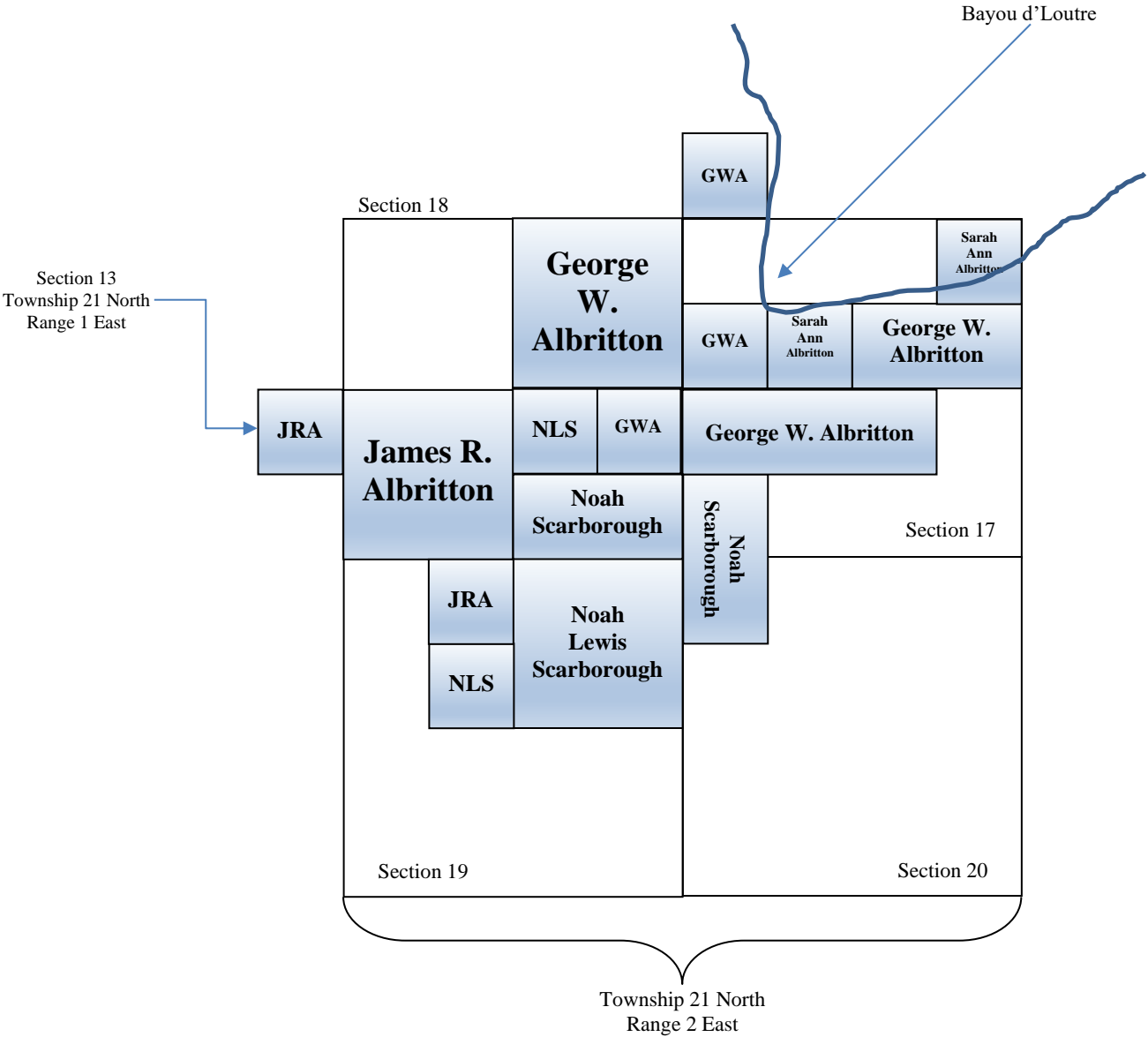

♦ ♦ ♦ ♦ ♦

Abstracts of Records of Richard & Sarah Fowler

During their married life together, Richard and Sarah Fowler lived in Columbus County North Carolina, Monroe (later Clarke), Dallas, and Wilcox Counties Alabama, and Union Parish, Louisiana. The list below contains abstracts of the known records they left in these locations.

1800 Federal Census for **John Fowler's** household in Lancaster District South Carolina includes a male born 1790–1800.

Reference: Lancaster District SC Federal Census, p. 178, line #9.

Comment: John Fowler's household included three males: one male aged 45 years and older (undoubtedly John Fowler), one male aged under 10 years (presumably Richard Fowler), and one male aged between 10 and 16 (presumably John W. Fowler).

1810 Federal Census for **J. Fowler's** household in Columbus County North Carolina includes a male born 1784–1794.

Reference: Columbus County NC Federal Census, p. 20, Line #16.

Comment: J. Fowler's household is undoubtedly that of John Fowler. Oddly, there is no older male listed that fits John Fowler's age, even though it appears to be his household.

1 Nov 1815 **Richard Fowler** and **Isaac Simmonds** witnessed a land transaction of 300 acres of land on the south side of Beaverdam Swamp from **John Slaughter** to **William Sikes**.

Reference: Columbus County NC Deed Book B, pp. 96–97.

26 Oct 1817 **Richard Fowler** and **William Sims** witnessed a land transaction of **John Edwards** to **John Fowler**. For \$100, Edwards sold Fowler two tracts of land in Columbus County "...lying...on the big branch of the beaver Dam Swamp." One tract consisted of 50 acres and the other tract adjoined land of **Smith**.

Reference: Columbus County NC Deed Book B, pp. 308–309.

19 Oct 1821 **Richard Fowler** of Monroe County, Alabama purchased 80.1 acres of land at the Cahaba, Alabama Government Land Office for \$100.12½.

Reference: Cahaba, Alabama Land Office Cash Entry #470. Richard paid \$100.12½ for precisely 80.1 acres, described as the

W½ of NE¼, Section 20, Township 8, Range 5

Comment: This land now lies in Clarke County, Alabama. Richard's cash came from two accounts: \$80 from "*Bank Darien Geo.*" And \$20 from "*Planters Bank Geo.*" He paid 12½ cents in "*Change.*"

19 Nov 1827 **Richard Fowler** of Monroe County, Alabama purchased 80.05 acres of land at the Cahaba, Alabama Government Land Office for \$100.06.

Reference: Cahaba, Alabama Land Office Cash Entry #3314. Richard purchased the

E½ of SW¼, Section 31, Township 13, Range 11

Comment: This land lies in Dallas County, Alabama, but on the county line between Dallas and Wilcox Counties. It lay a short distance northwest of the original location of the Village of Snow Hill (not the modern Snow Hill).

10 May 1828 **William Sikes** sells several tracts of land lying on the south side of beaver dam Swamp to **Duncan Sikes**, both of Columbus County North Carolina for \$100. One tract of 50 acres adjoined **Richard Fowler's** and **John Fowler's** lines, as well as **Elijah Nealy's**, **Joseph Nobles'**, and **William Sike's** lines. Another tract of 150 acres lay along **John Wilson's** line.

Reference: Columbus County NC Deed Book E, pp. 28–30. Abraham Fowler and Deliah Fowler witnessed the transaction.

4 Mar 1829 **Duncan Sikes** sells several tracts of land lying on the south side of beaver dam Swamp to **John Messer**, both of Columbus County North Carolina for \$100. One tract of 100 acres lay on **Richard Fowler's** lines. Another tract of 50 acres (bought from William Sikes in 1828) lay on **Richard Fowler's** corner

and **John Fowler's** line, and on **Elijah Nealy's**, **Joseph Nobles'**, and **William Sikes'** lines. Another tract of 150 acres lay on **John Wilson's** line.

Reference: Columbus County NC Deed Book H, pp. 214–215. E. Sellers and Samuel Wilson witnessed the transaction.

1830 Federal Census for **Richard Fowler's** household in Dallas County, Alabama shows him living on an adjoining farm to **Martin B. Lee**, **Addison Scarborough**, and **Simeon Scarborough**. Richard Fowler's household consisted of a total of nine white people and no slaves, including 1 male under 5 and one 30–40, and these females: 1 under 5, 1 aged 5–10, 3 aged 10–15, one aged 15–20, and 1 aged 40–50.

Reference: Dallas County AL Federal Census, p. 76, lines 2–5.

Comment: The age brackets given in Fowler's household perfectly match the births of his children listed in the Fowler Bible. The younger male is "*R. U. Fowler*" (presumably Walter R. Fowler), and the females are:

under 5: Susannah
5–10: Sarah Ann
10–15: Samantha, Milly, and Phiney/Sheny
15–20: Elvira

This implies that Richard and Sarah's eldest daughter, Elizabeth Fowler, who was born in February 1813, was already dead or married by 1830.

16 May 1831 **Richard Fowler** of Dallas County, Alabama bought 71.5 acres of land at the Cahaba, Alabama Government Land Office for \$89.38.

Reference: Cahaba, Alabama Land Office Cash Entry #7571. Richard purchased the
E½ of NW¼, Section 6, Township 12, Range 11

Comments: This land lay in Wilcox County, Alabama, but on the county line between Dallas and Wilcox Counties. It lay adjacent to Fowler's existing farm on the Dallas County side of the county line.

25 May 1831 **Enoch Albritton** of Wilcox County, Alabama bought 141.8 acres of land at the Cahaba, Alabama Government Land Office for \$177.25.

Reference: Cahaba, Alabama Land Office Cash Entry #7947. Albritton claimed the right of "*Preemption*," meaning that he had settled the vacant land, cleared acreage for agriculture, and established residence on it before the government offered the land for sale to the public. This gave him the right to purchase it before anyone else. Enoch Albritton bought the

SW¼ of Section 4, Township 12, Range 11

Comments: Enoch and his wife, Penelope Frizzle Albritton, sold this 141.8 acres to William Drake on 2 October 1833 (Wilcox County AL Deed Book C, p. 93). These documents do not themselves involve Richard Fowler. However, by August 1837, Richard Fowler owned the 141.8 acres that Drake purchased from Albritton in 1833. There is no recorded document showing the transfer from Drake to Fowler.

17 Jan 1833 **Richard** and **Sarah Fowler** of Dallas County, Alabama sold 240 acres of land in Dallas and Wilcox Counties to **Henry McCoghren** for \$800.

Reference: Dallas County AL Deed Book C, pp. 365–366. The Fowlers sold McCoghren this property:

- Dallas County land: SW¼ of Section 31, Township 13, Range 11 (160 acres)
- Wilcox County land: E½ of NW¼, Section 6, Township 12, Range 11 (80 acres)

Comments: The conveyance in which Fowler acquiring the W½ of SW¼ of Section 31, Township 13, Range 11 in Dallas County was not recorded in either Dallas or Wilcox Counties. Martin Batte Lee purchased this property from the government on 22 July 1828 (Cahaba, Alabama Cash Entry #3600) and apparently sold it to Fowler soon afterwards.

20 Oct 1834 The Wilcox County Probate Court appointed **Jesse Knight**, **Richard Fowler**, **Peter Knight**, **John Mitchel**, and **William Polk** appraisers of the estate of **Enoch Albritton**, deceased.

Reference: Wilcox County AL Probate Record Book 2, p. 319.

2 Oct 1835 In a document made in Montgomery County, Alabama, **Alexander Wilson**, **Amos Wilson**, **James Wilson**, **Bunberry Wilson**, and **Stephen Boswell**

*...appoint **John Wilson, Sr.** of the State and County aforesaid our Attorney in suit to transact any and all business Coming the Estate of **John Wilson** Dec'd. in the State of North carolina [sic] Columbus County and to receive moneys for and give receipts for us...to dispose [sic] of & make titles to any Land or negros or any other kind of property...*

Reference: Columbus County NC Deed Book F, pp. 38–39.

Comments: Although this record does not mention Richard Fowler, it is related to the one Fowler made a few weeks later. The wording of this documents seems to imply that the Wilsons and Boswell are heirs of John Wilson, whereas the wording of the Fowler-Robertson document below merely implies that Wilson owes them money.

17 Oct 1835 **Richard Fowler**, although technically then a resident of Wilcox County, made the following record:

*Alabama State, Clarke County...**Richard Fowler** and **William Robertson** of the County and State aforesaid...appoint **John Wilson** our lawful attorney for us and in our names and stead and to our use to ask demand sue for levey [sic] recover and receive all such sum or sums of money debts rents goods wares dues accounts and other demands whatsoever which are or shall be due owing payable and belonging to or detained from us by any maner [sic] of ways or means whatsoever by **John Wilson** of the State of Northcarolina [sic] and Columbus County and giving and granting unto our said attorney by these presents full and whole power strength and authority in and about the premises to have use and take all lawful ways and means in our names for the recovery thereof and upon the receipt of any such debts dues or sums of money aforesaid acquittance [sic] or other sufficient discharges for us and in our names to make seal and deliver and generally all and every other act and acts thing and things device and devices in the law whatsoever needful and necessary to be done in and about the premises for us and in our names to do execute and perform as fully largely and amply to intends and purpose as we might or could do if we were personally present or as if the matter required more special authority than is herein given shall lawfully do in and about the premises by virtue hereof...*

Reference: Columbus County NC Deed Book F, pp. 36–37.

Comments: This record proves extremely confusing. The precise relationship between Richard Fowler and William Robertson remains uncertain. Some have used this document as proof that Sarah Fowler was the daughter of John Wilson, but that is also not clear from the wording, as neither Fowler nor Robertson are described as Wilson's heirs. Wilson may have merely owed Fowler and Robertson money. All we know for certain is that Richard Fowler and John Wilson were neighbors in Columbus County prior to Fowler's migration to Alabama.

26 July 1837 **Richard Fowler**, with **Peter Lee**, **Martin B. Lee**, and **Robert Parrott** as his securities, all of Wilcox County, sign the following promissory note:

On or before the twenty sixth day of July 1838 we promise to pay to the cashier of the Branch of the Bank of the State of Alabama at Montgomery or order Four hundred seventy eight 63/100 Dollars for value received under the twenty first section of the act of July 1837 negotiated and payable at said Bank.

The four men also signed similar promissory notes due 26 July 1839 and 26 July 1840.

Reference: Wilcox County AL Deed Book E, pp. 151–152.

16 Aug 1837 **Richard Fowler** of Wilcox County, Alabama mortgages land to secure his debt of \$1363.56 to the Branch Bank of the State of Alabama at Montgomery. To secure the payment of his debt, Fowler uses the notes made a few weeks signed by him, **Peter Lee**, **Martin B. Lee**, and **Robert Parrott**.

Reference: Wilcox County AL Deed Book E, pp. 151–152. Richard Fowler mortgaged the following of land in Wilcox County to secure his notes. This property was his main farm at the time and lay in Section 4, Township 12, Range 11:

SW $\frac{1}{4}$ (141.8 acres) and SW $\frac{1}{4}$ of NW $\frac{1}{4}$ and E $\frac{1}{4}$ of NW $\frac{1}{4}$

Comments:

- 1) The record reads that Fowler owned the "east quarter" of the NW $\frac{1}{4}$ of Section 4, apparently a typographical mistake. An analysis of the surrounding land and later records indicates that Fowler owned the SE $\frac{1}{4}$ of NW $\frac{1}{4}$ of Section 4.

2) The conveyances in which Fowler purchased this property were not recorded in Wilcox County. Three men bought this property, and Fowler apparently bought the land from them shortly after they bought it from the government:

- a) Enoch Albritton purchased the SW $\frac{1}{4}$ of Section 4 on 25 May 1831 (Cahaba, Alabama Land Office Cash Entry #7947). He and his wife sold this property to William Drake on 2 October 1833 (Wilcox County AL Deed Book C, p. 93). There is no recorded deed in which Drake sells it to Fowler.
- b) David Seale purchased the SW $\frac{1}{4}$ of NW $\frac{1}{4}$ of Section 4 on 27 Nov 1833 (Cahaba, Alabama Land Office Cash Entry #17136).
- c) John W. Campbell purchased the SE $\frac{1}{4}$ of NW $\frac{1}{4}$ of Section 4 on 28 January 1834 (Cahaba Cash Entry #17889). The government patent to Campbell gave the incorrect land description; the patent stated that he bought the NE $\frac{1}{4}$ of NW $\frac{1}{4}$, but this land was purchased by Fowler's neighbor Addison Scarborough on 28 January 1834 and patented to him shortly afterwards.

24 Sept 1838 **Richard Fowler** witnessed the will of **Peter Lee** of Wilcox County, Alabama, along with **Jay McCondichie** and **John McCondichie, Sr.** Lee named his brothers, **Martin B. Lee** and **Eaton Lee**, as his executors but failed to name his wife or children.

Reference: Wilcox County AL Will Book 1 (Nov 1826–June 1844), pp. 316–318.

1840 The Wilcox County, Alabama Federal Census for **Richard Fowler's** household shows him living near his son-in-law, **Noah Scarborough**, as well as these neighbors: **Edmund Hobdy**, **William M. Purifoy**, and **Silas W. A. Albritton**. Fowler's household consisted of a total of nine people, including

1 white male aged 40–50	1 white female aged 40–50
1 white male aged 10–15	1 white female aged 20–30
2 male slaves aged 10–24	1 white female aged 15–20
1 female slave aged 36–55	1 white female aged 10–15
5 household members regularly engaged in agriculture	

Reference: Wilcox County AL Federal Census, p. 326, lines 17 (Scarborough) and 24 (Fowler).

Comment: The younger male is clear Fowler's son, who we presume is Walter R. Fowler (listed as "R. U. Fowler" in the Bible). The two younger females are Susannah (aged 10–15) and Sarah Ann (15–20). We presume that the female aged 20–30 is Milly Fowler, who would marry George W. Albritton in about 1842.

24 Nov 1840 **John R. Killingsworth** and **Eliza L. Killingsworth** sell to **Richard Fowler**, both of Wilcox County, Alabama, 30 acres of land for \$72.

Reference: Wilcox County AL Deed Book J, p. 594–595. Killingsworth sells Fowler the following property:

S $\frac{1}{4}$ of SE $\frac{1}{4}$, Section 17, Township 12, Range 11

...with the exception of ten (10) acres lying in the south west corner of said tract of land which I bargained sold and conveyed to James Hays...

Comment: The record describes the land as the "south $\frac{1}{4}$ quarter," which is undoubtedly a mistake. It appears that Fowler purchased the SE $\frac{1}{4}$ of SE $\frac{1}{4}$, which is a portion of the property he sold in November 1850 (see below). This 40-acre tract was purchased by William M. Polk at the Cahaba, Land Office on 3 September 1835 (Cahaba, Alabama Cash Entry #23896). Polk must have conveyed it to Killingsworth, who here sells it to Fowler.

16 May 1843 For \$131, **Thomas J. Watts** and **Silas W. A. Albritton**, "commissioners appointed by the Orphans Court of said County to sell the Lands belonging to the Estate of **John Stokes** dec^d," sell to **Richard Fowler** a tract of 40 acres of land in Wilcox County.

Reference: Wilcox County AL Deed Book G, p. 525. Watts and Albritton sell Fowler the following property

NE $\frac{1}{4}$ of SE $\frac{1}{4}$, Section 17, Township 12, Range 11

Comment: Richard Fowler's neighbor, Martin Batte Lee, had purchased this tract of land at the Cahaba Land Office on 23 May 1835 (Cahaba, Alabama Land Office Cash Entry #22699). Lee apparently soon sold the tract to his brother-in-law, John Stokes (Lee's wife, Levincy Albritton, was a sister to Stokes' wife, Mary Albritton).

22 Aug 1844 **Silas W. A. Albritton** and his wife **Sarah A. Albritton** sell to **Richard Fowler**, both of Wilcox County, Alabama, 38½ acres of land in Wilcox County for \$100.

Reference: Wilcox County AL Deed Book J, pp. 589–590. The Albrittons sell Fowler the following property, *“expressly that the party of the first reserves to themselves one acre and a half in the south east corner of said tract...already deeded to the use of the Male Academy.”*

NW¼ of SW¼, Section 16, Township 12, Range 11

26 Oct 1844 **Richard Fowler, Wm. M. Purifoy, and Edmund Hobdy** go on bond for \$2000 *“whereas Richard Fowler has been appointed Guardian of Sarah A. Elizabeth Robinson, John Robinson, and Roan Robinson, minor heirs of Amos Robinson, deceased.”*

Reference: Wilcox County AL Will Book 2, p. 166.

11 Oct 1845 **Richard Fowler** presented his annual settlement to the Court as guardian of the Robinson heirs.

Reference: Wilcox County AL Probate Record Book 5, p. 214.

19 Oct 1846 **Richard Fowler** presented his annual settlement to the Court as guardian of the Robinson heirs.

Reference: Wilcox County AL Probate Record Book 6, p. 15.

21 Dec 1846 **Richard Fowler**, Guardian of **Sarah A., John R., and Amos Roan Robinson**, minor heirs of **Amos Robinson**, deceased, *“produced to the [court] his account current and vouchers with said minors settlement of his Guardianship, up to this term of the Court.”* At the same court session, **Wiley J. Polk** applied for letters of Guardianship on the person and property of the Robinson minors, which the court granted. **A. B. Scarborough** and **John W. Purifoy** served as Polk’s securities on his bond.

Reference: Wilcox County AL Probate Record Book 6, pp. 47, 61–62, 67.

5 Apr 1847 **Wiley J. Polk** returned the Inventory of the minor heirs of the Estate of **Amos Robinson** to the Court.

Reference: Wilcox County AL Probate Record Book 6, pp. 132–133.

13 Nov 1850 **Richard Fowler** and his wife **Sarah Fowler** of Wilcox County, Alabama sell to **William M. Purifoy**, also of Wilcox County, 106.35 acres of land in Wilcox County for \$363.64. **F. M. Purifoy** and **S. W. A. Albritton** witnessed the transaction. **A. B. Scarborough** served as the justice of the peace who certified the conveyance, including an examination of Sarah Fowler apart from her husband at which she testified that she made the conveyance freely without any threats or compulsion from her husband.

Reference: Wilcox County AL Deed Book J, pp. 588–589. Richard and Sarah Fowler sell Purifoy the following land in Section 4, Township 12, Range 11:

W½ of SW¼ and SW¼ of NW¼

13 Nov 1850 **Richard Fowler** and his wife **Sarah Fowler** of Wilcox County, Alabama sell to **Francis M. Purifoy** also of Wilcox County 106.35 acres of land in Wilcox County, Alabama for \$363.64. **Wm. M. Purifoy** and **S. W. A. Albritton** witnessed the transaction. **A. B. Scarborough** served as the justice of the peace who certified the conveyance, including an examination of Sarah Fowler apart from her husband at which she testified that she made the conveyance freely without any threats or compulsion from her husband.

Reference: Wilcox County AL Deed Book J, pp. 590–591. Richard and Sarah Fowler sell Purifoy the following land in Section 4, Township 12, Range 11:

E½ of SW¼ and SE¼ of NW¼

13 Nov 1850 **Richard Fowler** and his wife **Sarah Fowler** of Wilcox County, Alabama sell to **Edmund Hobdy** also of Wilcox County 147 acres of land for \$272.75. **Wm. M. Purifoy** and **S. W. A. Albritton** witnessed the transaction. **A. B. Scarborough** served as the justice of the peace who certified the conveyance, including an examination of Sarah Fowler apart from her husband at which she testified that she made the conveyance freely without any threats or compulsion from her husband.

Reference: Wilcox County AL Deed Book J, pp. 593–594. The Fowlers sell Hobdy the following land in Township 12, Range 11:

Tract A: NW¼ of SW¼ of Section 16, “except one acre and a half in the south east corner, to wit commencing at the south east corner stake and runs seventy yards west thence one hundred and five yards north” (38.5 acres)

Tract B: SW¼ of SW¼ of Section 16, “except one acre and a half in the North East corner to wit one acre wide west and one acre and a half south, this exception is for the use and benefit of the school House so long as it is used for that purpose and when abandoned the said excepted peace [sic] of land belongs to the said E. Hobdy, his heirs and assigns with the rest of the above described land” (38.5 acres)

Tract C: E½ of SE¼ of Section 17, “with the exception of ten acres lying the south west corner” (70 acres)

Fowler acquired this property as follows:

Tract A: Fowler purchased this tract in 1844 from Silas W. A. Albritton (record abstracted above).

Tract C: Fowler acquired 30 acres in the SE¼ of SE¼ portion of Tract C from Killingsworth in 1840, and the 40 acres in NE¼ of SE¼ of Section 17 on 16 May 1843, from the executors of the Estate of John Stokes (records abstracted above).

Tract B: There is no record of Fowler acquiring Tract B. Section 16 was reserved exclusively for the use of the local schools. The government transferred this section to settles in 40-acre tracts with the agreement that schools would continually operate on portions of the property. Silas W. A. Albritton obtained Tract B from the government on 21 December 1844, so Fowler must have acquired it from Albritton between 1845 and 1850, with the transaction not recorded.

5 Dec 1850 **Wiley J. Polk** presents his final accounts as Guardian of **Sarah E.**, **John R.**, and **Roan A. Robinson** to the Wilcox County Orphans Court. Polk reports that each minor has credits of \$184.58.

Reference: Wilcox County AL Probate Record Book 7, p. 227.

22 Mar 1851 **Elvira Polk**, wife of **Wiley J. Polk**, residents of Union Parish, Louisiana, petition the Union Parish court:

*She has lately removed from the State of Alabama to your said Parish bringing with her three minor children **Sarah A. E.**, **John R.**, and **Roan A. Robinson** the issue of a former marage [sic] that the said minors are the owners of five negroes to wit a negro man **Edmund** and a negro woman **Ann** and their four children **Ned**, **Augusta**, **Georgia** and an infant two months old...*

Elvira Polk requests to be appointed natural tutrix and her husband **Wiley J. Polk** co-tutor and **Starling Lee** under tutor to the minors, who are “the sole surviving issue between **Elvira Polk** and **Amos Robinson** late of the State of Alabama and County of Clark dec’d.”

Reference: Union Parish LA Succession Book H-1, pp. 123–125.

17 Oct 1851 **Johnson Malone** sells land to **Richard Fowler**, both of Union Parish, Louisiana. Malone sells Fowler 237.39 acres of land for a total of \$1200, with \$600 paid in cash and promissory notes of \$300 each due 1 January 1853 and 1 January 1854. The transaction was witnessed by **John Taylor** and **Thomas J. Griffin**.

Reference: Union Parish LA Conveyance Book D, pp. 527–529. Malone sells Fowler the following tracts of land in Township 21 North, Range 2 East:

- NE¼ & NE¼ of SE¼ of Section 18
- SW¼ of NW¼ of Section 17

15 Jan 1852 **Samuel W. Hearn** sells to **Wiley J. Polk**, both of Union Parish, Louisiana, 160.3 acres of land for \$600, to be paid by 1 January 1853.

Reference: Union Parish LA Conveyance Book F, pp. 177–178. Hearn sold Polk the NW¼ of Section 32, Township 22 North, Range 1 East.

Jan 1852 **Hillory Ham**, the overseer of the Farmerville Road was assigned hands to work the road. Among those assigned to **Ham** were “**Mr. Fowler** and Hands.”

Reference: Union Parish LA Police Jury Minutes Book 1852–1869, p. 14, No. 23. The term “hands” generally referred to the slaves owned by the person.

June 1852 *"Jas. Perdue overseer on the road leading to Van Hooks old Bridge commencing at the Forts of the road below David Ward's and work to the Deluter [sic] and have the following hands subject to him for 1 year...Fowler's 2 Hands..."*

Reference: Union Parish LA Police Jury Minutes Book 1852–1869, p. 41.

8 Nov 1852 **Wiley J. Polk** sells to **William Rabun**, both of Union Parish, Louisiana, 160.3 acres of land for \$600.

Reference: Union Parish LA Conveyance Book F, pp. 178–179. Hearn sold Polk the NW¼ of Section 32, Township 22 North, Range 1 East.

7 Dec 1854 **James R. Albritton** buys 80 acres of land in Union Parish, Louisiana from **John H. Patterson** for \$300. The transaction was witnessed by **Noah Scarborough** and **John M. Lee**.

Reference: Union Parish LA Conveyance Record H, pp. 18–19. Patterson sold Albritton these two 40-acre tracts in Township 21 North, Range 1 East:

SE¼ of SW¼ of Section 4 & NE¼ of NW¼ of Section 9

Comment: James Rountree Albritton had married Richard Fowler's youngest daughter, Susan Fowler, in about 1851. Their eldest few children were born in Alabama.

3 Feb 1855 **S. W. Ramsey** sold property of the estate of **Henry R. Bryan**, deceased. Ramsey stated that he

...proceeded to sell...at the Courthouse Door in Farmerville, in said Parish, at Public auction to the highest bidder, a certain negro man Prince the property of the estate Henry R. Bryan Decd., and that after crying the said sale for a suitable time the same was adjudicated to Richard Fowler a resident of said Parish he being the highest and last bidder, bidding the sum of eleven hundred Dollars."

Ramsey thus sold to **Richard Fowler** "the negro slave Prince, about forty five years of age black color, and a slave for life..." The transaction was witnessed by **David Ward** and **Allen Stansell**.

Reference: Union Parish LA Conveyance Book G, pp. 172–173.

Comment: Prince's fate after his purchase by Fowler remains unclear. Of Fowler's known four sons-in-law, only three owned slaves in 1860: George W. Albritton (nine slaves), James R. Albritton (one slave), and Wiley J. Polk (twelve slaves). Prince would have been 50 years of age by 1860, and none of them own a slave near that age. Each of them owned only one adult male slave: James R. Albritton's was aged 37, George W. Albritton's was aged 32, and Polk's was aged 60.

1 Jan 1858 **James R. Albritton** sells to **John Steel**, both of Union Parish, Louisiana, 40 acres of land in Union Parish for \$200. The transaction was witnessed by **Martin B. Lee** and **John M. Lee**.

Reference: Union Parish LA Conveyance Record H, pp. 503–504. Albritton sold Steel the NE¼ of NW¼ of Section 9, Township 21 North, Range 1 East. Steel paid \$20 in cash and issued his promissory note for \$180 due 26 March 1858.

1 Jan 1858 **James R. Albritton** sells to **John M. Lee**, both of Union Parish, Louisiana, 39.95 acres of land in Union Parish for \$200 due on 1 March 1858. The transaction was witnessed by **Martin B. Lee** and **John Steel**

Reference: Union Parish LA Conveyance Record I, pp. 318–319. Albritton sold Lee the SE¼ of SW¼ of Section 4, Township 21 North, Range 1 East.

3 Jan 1858 **James R. Albritton** of Union Parish, Louisiana buys 160 acres of land in Union Parish from **James D. Griffin** via his attorney, **Henry Reganburg**, for \$325 cash.

Reference: Union Parish LA Conveyance Record H, pp. 456–457. Albritton purchased these tracts of land:

- SW¼ of SW¼ of Section 18, Township 21 North, Range 2 East
- N½ of SW¼ of Section 18, Township 21 North, Range 2 East
- NE¼ of SE¼ of Section 13, Township 21 North Range 1 East

7 Feb 1859 **George W. Albritton** purchases 200.93 acres of land in Union Parish, Louisiana "for use by me as an adjoining farm owned by me..."

Reference: Monroe, Louisiana Land Office Cash Entry #19759. Albritton stated that he had 75 acres in cultivation on his existing farm, which was described as the following tracts in Township 21, Range 2 East:

- NE¼ of SW¼ & NE¼ of SE¼ of Section 18

- SW $\frac{1}{4}$ of NW $\frac{1}{4}$ of Section 17

Comments: This property includes 80 acres that Richard Fowler purchased in 1851, implying that between 1851 and 1859, Fowler transferred at least this much of his farm to his son-in-law, George W. Albritton.

7 Feb 1859 **James R. Albritton** purchases 39.44 acres of land in Union Parish, Louisiana.

Reference: Monroe, Louisiana Land Office Cash Entry #19758. James R. Albritton purchased the SE $\frac{1}{4}$ of SW $\frac{1}{4}$ of Section 18, Township 21 North, Range 2 East for 75¢ per acre for a total payment of \$29.58.

24 Oct 1859 **James R. Albritton** of Union Parish, Louisiana purchases 40 acres of land from **Eli Owens**, also a resident of Union Parish, for \$74 in cash and a promissory note of \$50 with 8% interest from this date until paid. The transaction was witnessed by **Noah Scarborough** and **T. Owens**.

Reference: Union Parish LA Conveyance Record K, pp. 158–159. Owens sold Albritton the NE $\frac{1}{4}$ of NW $\frac{1}{4}$ of Section 19, Township 21 North, Range 2 East.

Comment: Eli Owens lived in the household that adjoined James and Susan Albritton in 1860.

28 Mar 1862 **James R. Albritton** and **Noah Scarborough** assist with appraising the estate of **Drury Cross** in Union Parish, Louisiana. Scarborough and former Judge **John Taylor** served as appraisers, with Albritton witnessing the appraisal.

Reference: Union Parish LA Succession Book E, pp. 592–600.

Comment: Albritton and Scarborough are sons-in-law of Richard and Sarah Fowler, having married Susan and Samantha Fowler, respectively.

6 Dec 1866 **James R. Albritton** swapped his 240-acre farm to **David W. Solomon** in exchange for Solomon's 240-acre farm. Both farms lay in close proximity, located about seven miles east of Farmerville. The transaction was witnessed by **Enoch R. Albritton** and **Noah Scarborough**.

Reference: Union Parish LA Conveyance Record L, pp. 374–377. All property involved lay in Township 21 North. Solomon sold Albritton this property:

- NW $\frac{1}{4}$ of NW $\frac{1}{4}$ of Section 31, Range 2 East, &
- E $\frac{1}{2}$ of SE $\frac{1}{4}$ of Section 25, Range 1 East &
- E $\frac{1}{2}$ of NE $\frac{1}{4}$ & SW $\frac{1}{4}$ of NE $\frac{1}{4}$ of Section 36, Range 1 East

Albritton sold Solomon this property:

- SW $\frac{1}{4}$ of Section 18, Range 2 East, &
- NE $\frac{1}{4}$ of NW $\frac{1}{4}$ of Section 19, Range 2 East &
- NE $\frac{1}{4}$ of SE $\frac{1}{4}$ of Section 13, Range 1 East

Comment: Solomon's wife, Mary Ann Scarborough, the daughter of Samantha Fowler Scarborough, was the niece of Albritton's wife, Susannah Fowler. This land swap may have been in preparation for James and Susan to leave Union Parish and return to Wilcox County, Alabama, although it appears they did not leave until the winter of 1868–1870.

1867–1868 **James R. Albritton** did not pay taxes on his Union Parish farm in 1867 or 1868, either as a resident or non-resident. However, **G. W. Albritton** paid the taxes on a 200-acre farm in both years, even though George's widow, **Sarah A. Fowler Albritton**, was listed as the owner of her husband's farm in both years. The 1868 assessment indicated that the farm on which G. W. Albritton paid taxes consisted of 170 acres of uncultivated land, 10 acres planted in cotton, 20 acres planted in corn, with no bushels of corn nor any bales of cotton produced the in the year 1867.

Reference: 1867–1868 Union Parish LA Tax Assessments.

Comment: This tax information suggests that James R. and Susan Fowler Albritton did not cultivate the new farm they had purchased from her niece and nephew, Mary Ann Scarborough and David W. Solomon, in December 1866. Since it appears that James R. Albritton had arranged for his uncle, George W. Albritton, to pay his taxes, it is possible that James and Susan departed from Union Parish in the winter of 1866–1867 for Wilcox County, Alabama, where we know they were by 1869.

13 Oct 1868 **James R. Albritton** of Union Parish, Louisiana sells 40 acres of land to **John M. Gulley**, also a resident of Union Parish, for \$50 in cash. The transaction was witnessed by **J. W. Reid** and **W. C. Smith**.

Reference: Union Parish LA Conveyance Record M, pp. 246–247. Albritton sold Gulley the SW¼ of NE¼ of Section 36, Township 21 North, Range 1 East.

Comments: After this transaction, James R. Albritton's Union Parish farm consisted of 200 acres of land. There is no recorded transaction in Union Parish showing him conveying title of his farm to his brother, John Thomas Albritton. However, records below from 1875 show that he had indeed sold the farm to his brother by January 1875.

19 Nov 1868 **James R. Albritton** witnesses the inventory of the estate of his uncle, **George W. Albritton**,

Reference: Union Parish LA Succession Book G, p. 159.

Comments: This is the last known record of James R. Albritton in Union Parish. During the winter of 1868–1869, James and Susan moved their family back to Snow Hill. On 14 April 1869, their daughter, Mary Janes Albritton, married William Madison Purifoy, Jr. in Wilcox County, Alabama. Susan and James' son, John W. Albritton, married in September 1871 in Dallas County, Alabama.

19 Nov 1868 The Succession of **George W. Albritton**, deceased, includes the entire farm purchased by **Richard Fowler** in 1851, including 80 acres owned by Albritton on 7 February 1859.

Reference: Union Parish LA Succession Book G, pp. 154–160. The real estate owned by Albritton included a total of 438.32 acres, including these tracts of land in Township 21, Range 2 East. This property includes the entirety of what Fowler bought from Johnson Malone in 1851:

- NE¼ & NE¼ of SE¼ of Section 18
- N½ of SW¼ & NW¼ of SE¼ & S½ of NE¼ & SW¼ of NW¼ of Section 17

Comments: There is no recorded conveyance in Union Parish, Louisiana from Fowler to Albritton, nor was any succession ever made on Richard Fowler's estate. Since Albritton initially settled a few miles away from the adjoining Fowler-Scarborough farms, it seems likely that Fowler deeded his farm to Albritton prior to his death, probably in the latter 1850s.

1869 **Enoch R. Albritton** paid the taxes on the Union Parish, Louisiana farm of his first cousin and uncle by marriage, **James R. Albritton**, as James' "*agent*." James R. Albritton's farm was valued at \$400, and consisted of 160 acres uncultivated, 20 acres cultivated in cotton, 20 acres cultivated in corn. The farm was not listed as producing any corn or cotton in 1868.

Reference: 1869 Union Parish LA Tax Assessments.

Comment: This gives further evidence that James R. Albritton had returned to Snow Hill, in Wilcox County.

18 Jan 1875 In a record made in Robertson County, Texas, **John T. Albritton** and his wife, **Nancy M. Albritton**, gave their power of attorney to **John M. Lee** of Union Parish, Louisiana, giving him authority to sell 200 acres they owned in Union Parish, Louisiana "*known as the Albritton tract*."

Reference: Union Parish LA Conveyance Record P, p. 306.

Comments: John M. Lee was the first cousin of John Thomas Albritton, as Lee's mother, Lavincy Albritton Lee, and Albritton's father, Allen Albritton, were siblings, children of Enoch Albritton and Penelope Frizzle of Snow Hill, Wilcox County, Alabama.

3 Feb 1875 **John M. Lee**, as attorney for **John T. & Nancy M. Albritton** of Robertson County, Texas, sells 200 acres of land to **Thomas A. Dean** for \$400, with \$100 received in cash and \$300 due 1 January 1876 by promissory note.

Reference: Union Parish LA Conveyance Record P, pp. 307–308. All property involved lay in Township 21 North. Through their attorney, John T. and Nancy M. Albritton sold Dean this property:

- NW¼ of NW¼ of Section 31, Range 2 East, &
- E½ of SE¼ of Section 25, Range 1 East &
- E½ of NE¼ of Section 36, Range 1 East

Comment: This land is clearly that which James R. Albritton purchased from David W. Solomon in 1866 (see above), except for the 40 acres James R. Albritton sold to Gulley in 1868. James must have conveyed his land to his brother between December 1866 and 1874.



The Richard & Sarah Fowler Family Bible

The following is a precise transcript of the information recorded on the family pages of Richard and Sarah Fowler's Family Bible. The Bible is now owned by my cousin, Ms. Barbara Brantley. It is fragile and the writing quite faded and difficult to read in places. In particular, several of the Fowler daughters have their nicknames recorded in the Bible rather than their full names. Several different descendants have transcribed the information from the Bible, and most of them have made the same mistake, interpreting the Bible entry recording the birth of Richard and Sarah's daughter "Mantha" as "Martha." This mistake is understandable, as "Mantha" is not a common name, and unless you read the Bible entry carefully, the "n" resembles an "r." But a meticulous examination reveals that the entry is indeed for "Mantha Fowler," the name she went by as a child and young woman. In her later years, she went by "Samantha."

The spellings punctuation used in the transcription below are precisely as in the original Bible record. The Bible was published in 1835, so all births recorded on the first page were written after those events occurred. It is not known who recorded the Fowler births on the first page.

The Original Pages of the Richard & Sarah Fowler Bible

Page 1

1. *Elisabeth Fowler Was Born February 2nd in the Year of Our Lord 1813*
2. *Elvy Fowler Was Born June 24th 1814*
3. *Sheny Fowler Was Born January 22nd 1816*
4. *Milly Fowler Was Born December 23d 1817*
5. *Mantha Fowler Was Born November 19 1819*
6. *Sarah an Fowler Was Born Aug 22nd 1823*
7. *R. U. Fowler Was Born June 26th 1825*
8. *Susanah Fowler Was Born Dec 3d 1827*

Parents Age

Richard Fowler was Born Jan 17th 1792

Sarah Fowler Was Born May 3d 1790

Page 2

Wm F. Robinson was Born February 10th 1836
Enoch Richard Albritton Was Borne June the 20 1843
James Adrew Albritton Was Borne July 13 1846
George Anderson Albritton was born on march the 15 1870
Eliza Roann Albritton was born march the 22 1872
Gorver Sharrock was born Oct 1 1900
Joseph Washington Dean was born March the 4 1876
Thomas Birtum Dean was born August the 16 1877
Sallie May Dean was born May the 20 1879
Caray Etta Dean was borned July th 5 1881
Addie Pearl Dean Was borned Aug the 7 1884
Lissi Dean Was born November the 24 1885

Page 3

Sarah an Albritton died 4th of Oct 1875 aged 52 yrs 1 month and 12 days
George W. Dean Was borned december the 21 1888
Eunice Dean was borned march th 20 1891
Emma Rebecca Dean Was borned May th 6 1893

Comments

1. All the births recorded on the second and third pages, except for William F. Robinson, are known to be the children, grandchildren, or great-grandchildren of Richard and Sarah Fowler. Enoch Richard and James Andrew Albritton are sons of George Washington Albritton and his first Fowler wife. George and Eliza Albritton were children of James Andrew Albritton. The Dean entries are for the children of Thomas Allen Dean and Rebecca Francis Albritton, the eldest child of Sarah Ann Fowler and George W. Albritton. "*Gorver Sharrock*" should be "*Grover Sharrock*," is the daughter of Caray Etta Dean Sharrock. Grover was actually born in 1905, not 1900 as recorded in the Bible.
2. The first entry recorded in the Bible on page two was William F. Robinson. We cannot positively identify this person, although it seems certain that he is a grandson of Richard and Sarah Fowler. Their daughter "*Sheny*" or "*Phiney*" married to William Robinson/Robeson in Wilcox County, Alabama on 28 December 1834. Since every other Bible entry is for a child, grandchild, or great-grandchild of Richard and Sarah Fowler, undoubtedly William F. Robinson must also be one of their grandchildren. Richard and Sarah's daughter Elvira (Elvy) married Amos Robinson in August 1835, but unless it was a *shotgun* wedding, there was not enough time following their marriage for William to have been Elvira's son. In addition, none of the known children of Elvira and Amos Robinson had their births recorded in the Bible.

♦ ♦ ♦ ♦ ♦ ♦

Richard & Sarah Fowler's Children

The Fowler Family Bible includes the names of Richard and Sarah's children. We assume that the Bible lists all of their children, as we have no evidence that implies they had any additional children.

1. **Elizabeth Fowler** (2 Feb 1813–?).

- Persistent family tradition states that George Washington Albritton married two Fowler sisters, daughters of Richard Fowler. The second is known to have been Sarah Ann Fowler, but there is little documentation of the name of the given name of Albritton's first wife. Family tradition states that she was Elizabeth, the eldest daughter of Richard Fowler. However, the 1830 census indicates that Elizabeth was either already married or deceased by 1830.
- The only known documentation for the given name of George W. Albritton's first wife is the death certificate of Enoch Richard Albritton, his eldest son. That record gives Enoch's mother's name as "*Milly Fowler*." Based upon this information, we presume that the family tradition related during the twentieth century is incorrect.

2. **Elvira Fowler** [Elvy] (24 Jun 1814–aft. 1880) married on 20 August 1835 in Clarke County, Alabama to **Amos Robinson** (1810/1820–c1843). Elvy Fowler Robinson married 1845/1846, in Clarke or Wilcox County, Alabama, to **Wiley J. Polk** (c1811–after 1880), son of **Abel Polk** (1 May 1777–17 Sept 1834) and **Eunicey Paramore** (18 Oct 1774–?).

- Wiley J. Polk posted bond to marry Sarah Ann Gaesler in Wilcox County, Alabama on 14 January 1843, with George E. Polk as his security (Wilcox County Loose Original Marriages).
- Elvira and her children lived in Clarke County, Alabama with her second husband in 1850. That winter, it appears that she and her family accompanied her parents on their move to Union Parish, Louisiana. On 22 March 1851, Elvy and Wiley petitioned the Union Parish Court to appoint them guardians of the three minor children of Elvira and Amos Robinson. The petition stated that the minors owned a family of slaves: Edmund and Ann, along with their four children: Ned, Augusta, Georgia, and "*an infant two months old*" (Union Parish LA Succession Book H-1, pp. 123–125).
- On 15 January 1852, Wiley J. Polk purchased an 80.15-acre farm in Union Parish near the farms of his relatives. He sold this farm that winter, on 8 November 1852 (Union Parish LA Conveyance Record F, pp. 177, 179).
- It is unclear how long Elvira and Wiley J. Polk lived near her relatives in Union Parish, but they may have remained there until after Richard Fowler's death in the latter 1850s.
- By about 1858, Elvy and Wiley Polk had moved to De Soto Parish, Louisiana, where they purchased government land. They remained there until their deaths, which occurred sometime after 1880.
- Polk family research compiled in 1989 stated that Wiley J. Polk was the son of Abel Polk (1 May 1777–17 Sept 1834) and Eunicey Paramore, born 18 October 1774. It also stated that Wiley was born on 21 July 1812. This research report stated that two of Wiley's sisters married Albritton brothers: Mary Polk (born 23 October 1800) married John F. Albritton and Eunicey Polk (12 Feb 1802–12 Oct 1842) married Silas White Arnett Albritton. This research is unsubstantiated, with no indication of the sources for these dates.

3. **Sheny/Phiney Fowler** (22 Jan 1816–?) married on 28 December 1834 in Wilcox County, Alabama to **William Robeson** (Robinson?).

- Richard Fowler's family Bible records this daughter's name as "*Sheny*," but the entry proves difficult to decipher and is likely a nickname, as many of the other entries were. On 28 December 1834, a Phiney Fowler married to William Robeson in Wilcox County. Since there were no other Fowler families in Wilcox County during this time period, it is likely that Phiney was a daughter of Richard. If so, the only reasonable possibility is that "*Sheny*" and "*Phiney*" are the same person.
- One bit of data supports the hypothesis that Sheny/Phiney Fowler are the same daughter of Richard Fowler: among the grandchildren of Richard Fowler whose births are recorded in his Bible is the birth of William F. Robinson, born 10 February 1836. Although Elvira Fowler married Amos Robinson, this marriage took place 20 August 1835, nearly six months before the birth of William F. Robinson. Although it is possible that William F. Robinson was a child of Elvira Fowler Robinson who died young (he could have been premature or perhaps Elvira and Amos "had" to get married), it seems just as likely, if not moreso, that "*William Robeson*" was actually "*William Robinson*," that "*Phiney Fowler*" and "*Sheny Fowler*" were the same person, and that the William F. Robinson born 10 February 1836 was their son.
- No further record has been found of any of either Sheny/Phiney, William Robeson/Robinson, or William F. Robinson.

4. **Milly Fowler** (23 Dec 1817–1846/1847) married about 1842, probably in Wilcox County, Alabama, to **George Washington Albritton** (23 Oct 1810–28 Oct 1867), son of **Enoch Albritton** (1771–14 Feb 1834) and **Penelope Frizzle** (27 Jan 1772–after 1860).
 - Milly's name was likely "*Amelia*," the name of one of Richard Fowler's sisters.
 - As described above, family tradition among the Albritton and Scarborough families of eastern Union Parish, Louisiana state with certainty that George Washington Albritton married two Fowler sisters, daughters of Richard and Sarah Fowler. However, the tradition states that their eldest daughter, Elizabeth, was his first wife. This does not match the census records, which suggest that Elizabeth was already married or deceased by 1830. Moreover, the death certificate of George W. Albritton's eldest son, Enoch Richard Albritton, gives his mother's name as "*Milly Fowler*."
 - Milly Fowler Albritton's precise date of death is not known. Evidence suggests that her two sons remained in Snow Hill while George W. Albritton accompanied Milly's sister, Samantha Fowler Scarborough, and her family to Union Parish, Louisiana (Milly's son, Enoch R. Albritton, stated in 1911 that he had lived in Louisiana since 1850, while Samantha's daughters said they arrived in 1847). This suggests that Milly perhaps died in childbirth or shortly after the birth of her second son, James Andrew Albritton, on 13 July 1846. This would explain the delayed arrival in Louisiana of Milly's sons.
5. **Samantha Fowler** [Mantha, Manthy] (19 Nov 1819–28 Nov 1905) married on 5 November 1837 in Wilcox County, Alabama to **Noah Lewis Scarborough** (c1808–1881/1882), son of **Addison Scarborough** (c1780–1868). Samantha and Noah are buried in the Taylor/Liberty Hill Cemetery, Farmerville, Union Parish, Louisiana.
 - Samantha and Noah lived near Snow Hill on their parents' farms until 1847. At that time, they moved to Union Parish, Louisiana, together with her brother-in-law, George Washington Albritton and his sister, Levincy Albritton Lee and her husband, Martin Batte Lee.
 - Samantha and Noah purchased a farm located about seven miles east of Farmerville. Within a few years, many of Samantha's relatives had purchased adjoining farms, including her parents, Richard and Sarah Fowler, her sisters and brothers-in-law Sarah Ann Fowler Albritton and George W. Albritton, Susan Fowler Albritton and James R. Albritton, and Elvira Fowler Polk and Wiley J. Polk
6. **Sarah Ann Fowler** (22 Aug 1823–4 Oct 1875) married on 3 January 1850 in Wilcox County, Alabama to **George Washington Albritton** (23 Oct 1810–28 Oct 1867), son of **Enoch Albritton** (1771–14 Feb 1834) and **Penelope Frizzle** (27 Jan 1772–after 1860). Sarah Ann and George W. Albritton are buried in the Taylor/Liberty Hill Cemetery near their old farm, several miles east of Farmerville, Union Parish, Louisiana.
 - George W. Albritton first married Sarah's older sister, Milly Fowler. After giving birth to two sons, Milly died. It is not known whether she died in childbirth in Alabama or made the trip to Louisiana with George and died there. Since her eldest son, Enoch Richard Albritton, later stated that he arrived in Union Parish in 1850, it would appear that she died prior to George's departure from Alabama in 1847/1848.
 - Albritton left Snow Hill Alabama during the winter of 1847/1848 with his sister-in-law, Samantha Fowler Scarborough and her husband, Noah Scarborough. They settled in Union Parish, Louisiana that winter on farms located several miles east of Farmerville. It appears that Albritton left his young sons, a four-year old and one-year old, in Alabama with the Fowlers. Albritton returned to Wilcox County during the winter of 1849–1850, married Sarah Ann, and then returned to Louisiana with his new wife, sons, and mother, Penelope Frizzle Albritton.
7. **R. Walter Fowler** (26 June 1825–after 1850) married on 12 May 1847 in Clarke County, Alabama to **Laura A. Talbert**.
 - Richard Fowler's Family Bible lists the name of his only son as "*R. U.*" The Bible clearly gives the second initial as a "*U*" and not a "*W*," but we believe that the man named "*Walter R. Fowler*" who married Laura A. Talbert in Clarke County, Alabama is Richard's son.
 - We have no record of R. Walter Fowler after his 1847 marriage. However, Richard Fowler's household on the Wilcox County, Alabama State Census includes a white male over the age of twenty-one but under forty-five, and a white female who could be his wife. Richard and Sarah Fowler left Snow Hill in November, and so the federal census enumerator missed them. This suggests that R. Walter Fowler died sometime after 1850.
8. **Susannah Fowler** [Susan] (3 Dec 1827–28 Sept 1909) married about 1851, probably in Wilcox County, Alabama, to **James Rountree Albritton** (22 Dec 1826–21 June 1911), son of **Allen Albritton** (17 Nov 1794–8 Dec 1861) and **Susanna Ford** (17 June 1803–12 Oct 1867). Susan and James are buried in the Bazette Cemetery, Navarro County, Texas.
 - Susannah Fowler was born when her parents still lived in Clarke (Monroe) County, Alabama. They moved to their new farm on the county line of Wilcox/Dallas County in 1828, when she was still an infant.

- Two sources give the birth of Susan's husband, James Rountree Albritton, as occurring in December 1826: his death certificate and their double tombstone in the Bazette Cemetery in Bazette, Navarro County, Texas. However, the tombstone puts his birth on December 27 while his death certificate, with information supplied by his daughter, says December 22. His death certificate also states that his precise age at his death was 84 years, 5 months, and 29 days, which fits very close to a birth date of December 22nd.
- Susan and her parents were missed on the 1850 census, although they remained residents of Snow Hill until November 1850 (the same month the census enumerator visited Snow Hill). Susan apparently married James R. Albritton in late 1850 or 1851, presumably in Wilcox County, Alabama. Their marriage record is among those missing from the courthouse. If Susan and James married in late 1850, then Susan remained in Alabama as a newlywed while her parents and sister, Elvira, moved to Louisiana to join Samantha and Sarah Ann. If Susan did not marry until 1851, then she may have made the trip to Louisiana with her family and later returned to Alabama.
- James Rountree Albritton was apparently listed twice on the 1850 census. He was listed in his father's household in Wilcox County near Snow Hill as a 23-year-old farmer (1850 Wilcox County AL Federal Census, p. 393, Household #723, dated November 17). Albritton was also listed in nearby Lowndes County, in the household of planter Joseph Soles, as "*J. R. Albritton*," a 23-year-old Overseer (1850 Lowndes County AL Federal Census, p. 129, Household #392, dated October 24).
- Susan and James followed her parents and sisters to Union Parish, Louisiana in the fall of 1854. They purchased a farm near their relatives in December 1854 but sold it in January 1858 and purchased the farm of former Snow Hill resident, James D. Griffin, son of James Griffin, one of the deacons of Snow Hill's Bethsaida Baptist Church. This farm adjoined that of Susan's father and sister, Samantha Scarborough. It appears that Richard Fowler died in 1858, and Susan's sister, Sarah Ann Albritton acquired the Fowler farm. Thus, between January 1858 and December 1866, the three Fowler sisters Susan and Sarah Ann Albritton and Samantha Scarborough all lived on adjoining farms on Bayou d'Loutre. Their father died in 1858 and their mother in November 1859.
- The 1860 census enumerator incorrectly listed James' name as "*Wm. R. Albritton*" on the Population Schedule, but both the Agricultural and Slave Schedules recorded it as "*J. R. Albritton*." Clearly the enumerator merely recorded James' name incorrectly on the Population Schedule.
- In December 1866, James R. Albritton swapped his farm with that of his wife's niece, Mary Ann Scarborough Solomon and her husband, David Ward Solomon, located nearby. It does not appear that James and Susan operated their new farm but probably left in 1866 for Wilcox County, Alabama. James R. Albritton did not pay the taxes on his farm in either 1867 or 1868; instead, taxes were paid on 200 acres by his uncle and brother-in-law, George W. Albritton. On 13 October 1868, James R. Albritton sold 40 acres of his farm, leaving his farm at 200 acres. Tax records show that in 1867, 10 acres of the farm was cultivated in cotton and 20 acres in corn, but no corn or cotton were produced. This suggests that the farm was rented out or operated by sharecroppers, and James R. Albritton did not cultivate it himself. In 1869, taxes on the James R. Albritton farm were paid by his first cousin, Enoch R. Albritton. Again, in 1868, no cotton or corn were produced by James R. Albritton, although 20 acres each were cultivated in cotton and corn.
- Susan and James were documented in Wilcox County by 14 April 1869, when their eldest daughter, Mary Jane Albritton, married William Madison Purifoy, Jr., the son of Richard and Sarah Fowler's old neighbor, William Madison Purifoy, Sr. (11 Nov 1810–7 July 1863). Susan and James have not been located on the 1870 census, although the records indicate they remained in the Snow Hill area. In 1870, Susan and James' daughter, Mary Jane Albritton Purifoy, lived next to James' brother, John T. Albritton in Snow Hill. On 27 September 1871, Susan and James' eldest son, John Wilson Albritton, married in Dallas County. John and his wife had two sons who died as infants and are buried in the Snow Hill Cemetery in 1873 and 1874. Thus, it appears that Susan and James Albritton remained in Snow Hill until about 1874 or 1875.
- Sometime between 1866 and 1874, James and Susan conveyed their 200-acre Union Parish farm to his brother, John Thomas Albritton. By 18 January 1875, John T. Albritton and his wife, Nancy M. Taylor Albritton, had left Snow Hill and moved to Robertson County, Texas. On that day, they appointed John's first cousin, John M. Lee (son of Lavincy Albritton Lee) as their attorney to sell 200 acres they owned in Union Parish "*...known as the Albritton tract...*," the former farm of James and Susan Albritton (Union Parish LA Conveyance Book P, pp. 306–308; Lee sold the Albritton farm to Thomas A. Dean on 3 February 1875 for \$400). The conveyance of James R. Albritton to his brother, John T. Albritton, was not recorded in Union Parish.
- Several of Allen Albritton's sons left Snow Hill for the Navarro-Freestone County, Texas region about 1874, including James R., John T., and Allen K. Albritton. James and Susan lived in Freestone County in 1880. In December 1887, they moved to Navarro County. By 1900, they lived in Clay County, Texas near the Oklahoma border with two of their daughters.

- James R. Albritton's youngest daughter, Susan Elvira Albritton Oliver, provided the information for his death certificate. He died in Bellevue, Clay County, Texas of *"apoplexy."* Dr. D. W. Holmes stated that *"First stroke on June 1 and a second on June 19th 1911."* His daughter gave James' full name as *"James Roundtree Albritton,"* using the common incorrect spelling of the family name of his great-grandmother, *"Rountree."* Elvira Albritton Oliver also gave his father's name as *"Richard Albritton."* It appears that she confused the names of her two grandfathers, Allen Albritton and Richard Fowler. There was no *"Richard Albritton"* in this family.

♦ ♦ ♦ ♦ ♦ ♦

Known Grandchildren and Great-Grandchildren of Richard and Sarah Fowler

This section gives information on Richard and Sarah Fowler's known grandchildren and great-grandchildren. More detailed information on their Albritton and Scarborough descendants is found in the separate notes on their daughters who married into those families.

1. Elizabeth Fowler

Elizabeth Fowler (2 Feb 1813–?) left no known descendants.

♦ ♦ ♦ ♦ ♦

2. Elvira Fowler

Elvira Fowler [Elvy] (24 Jun 1814–aft. 1880) married on 20 August 1835 in Clarke County, Alabama to **Amos Robinson** (1810/1820–c1843). Elvy Fowler Robinson married 1845/1846, in Clarke or Wilcox County, Alabama, to **Wiley J. Polk** (c1811–after 1880). Elvira and Wiley Polk had no known children. Known children of Elvira Fowler and Amos Robinson:

1. [male] **Robinson** (c1836/1837–pre-1844).
 - The 1840 Clarke County AL Federal Census (p. 250, line 18) gives the household of Amos Robinson with three children under 5 years of age: two males and one female. Assuming all three were children of Elvira and Amos, then one of the males was likely born first, about 1836. If correct, this male child died prior to 26 October 1844, when the court appointed Richard Fowler as guardian of the surviving Robinson heirs.
2. **Sarah Ann Elizabeth Robinson** (19 Sept 1838–29 June 1856).
 - Court records of both Wilcox County, Alabama and Union Parish, Louisiana indicate that Sarah Ann Robinson was alive in the 1840s and early 1850s, even though she was not living with her mother in 1850. These court records also indicate that she was the eldest child of Elvira and Amos. Her precise dates of birth and death come from family information obtain in 2001.
3. **John R. Robinson** (3 Feb 1840–30/31 July 1861).
 - John lived with his mother and stepfather in Clarke County, Alabama in 1850 and De Soto Parish, Louisiana in 1860.
 - He enlisted as a private in Company F, 9th Regiment Louisiana Infantry in early 1861. His enlistment records indicate that he was a resident of Mansfield and a student. Robinson's company was raised in De Soto Parish. He officially entered the Confederate service at Camp Moore on 7 July 1861, and his unit immediately left for Virginia.
 - Robinson died at Manassas Junction of sickness. His military records give his death date as July 30, whereas family information gives it as July 31. His precise date of birth also comes from these family records.
4. **Roana Amos Robinson** (10 Sept 1843–30 Apr 1928) married about 1859/1860, probably in De Soto Parish, Louisiana, to **Henry H. Howell** (2 Oct 1838–10 May 1911), son of **James Howell** and **Narcissa ?** Roana and Henry Howell are buried in the Allen Cemetery near Mansfield, De Soto Parish, Louisiana.
 - Court and census records as well as her tombstone give her name as "*Roana*," but some descendants insist her full name was "*Rosannah*."
 - The 1900 and 1910 censuses indicate that Roana had given birth to thirteen children, eleven of whom were then alive.

Known children of Roana and Henry Howell:

- a. **Fredonia N. Howell** (20 Dec 1860–15 July 1950) married **West W. Williams** (9 Mar 1853–15 Dec 1926). Fredonia and West are buried in the Allen Cemetery near Mansfield, De Soto Parish, Louisiana.
 - The 1870 census listed her name as "*Marcina Howell*."
- b. **Henryeta Howell** (11 Oct 1862–1862/1870).
 - Her name and birth date come from family information. She died prior to 1870.
- c. **Harrieta Howell** (1 May 1864–1864/1870).
 - Her name and birth date come from family information. She died prior to 1870.
- d. **John Daniel Howell** [Johnie] (20 Apr 1865–31 Jan 1926) married **Mary Lu Fincher** (2 Apr 1873–10 July 1932). Johnie and Mary Lu Howell are buried in the Allen Cemetery, Mansfield, De Soto Parish, Louisiana.
- e. **William A. Howell** (1866–10 Nov 1916) died in De Soto Parish, Louisiana.
- f. **Sarah E. Howell** [Sallie] (17 July 1868–28 Dec 1967) married on 22 January 1886, probably in De Soto Parish, Louisiana, to **Christopher Columbus Williams** (9 Jan 1862–16 July 1921). Sallie and Christopher Williams are buried in the Allen Cemetery, Mansfield, De Soto Parish, Louisiana.
- g. **Lawrence James Howell** (11 Dec 1869–18 Feb 1934) married **Nellie Grace Franklin** (19 Nov 1873–19 Jan 1955), daughter of **James O. Franklin** and **Frances Rebecca Smith** (9 Aug 1850–1932). Lawrence and Grace Howell are buried in the Colorado City Cemetery, Colorado City, Mitchell County, Texas, Plot LW-04-09.
 - His death certificate gave his name as "*James Lawrence Howell*," but it also listed his wife as "*Grace Helen Franklin*," while her tombstone was inscribed as "*Nellie G.*" It stated that Howell worked as a

farmer, and that he died of Bright's Disease. Her death certificate listed her name as "*Nellie Grace Howell*," daughter of James O. Franklin and Frances R. Smith. She died of diabetes.

- h. **Elvira Ann Howell** [Ellie, Ella] (27 Jan 1872–19 Aug 1949) married **Jefferson Davis Williams** [Jeff] (11 May 1862–13 Oct 1931), son of **Thomas Jefferson Williams** and **Judith Fletcher**. Ellie and Jeff are buried in the Allen Cemetery, Mansfield, De Soto Parish, Louisiana.
 - i. **Henry Bulah Howell** (25 June 1873–27 Nov 1951) married **Sarah Alice Mathis** (30 Sept 1879–30 Aug 1951), daughter of **Thomas Lafayette Mathis** (15 Sept 1833 – 31 Jan 1914) and **Julia Whitney** (15 Nov 1844–17 Nov 1929). Henry and Sarah are buried in the Vivian Cemetery, Vivian, Caddo Parish, Louisiana.
 - j. **Albert Galitan Howell** (27 Feb 1875–26 Aug 1947) married in 1896 to **Sarah Alice Hamilton** [Sallie] (8 Aug 1879–26 Nov 1938), daughter of **William Parish Hamilton** (16 Oct 1843–16 Mar 1922) and **Sarah Ann Glover** (26 Jan 1848–23 July 1913). Albert and Sarah Howell are buried in the Rockdale Cemetery, New Rockdale, De Soto Parish, Louisiana.
 - k. **Addie Robena Howell** (5 Jan 1877–3 July 1956) married **Eddie L. Mathis** (13 June 1873–24 Apr 1951). Addie and Eddie Mathis are buried in the Highland Cemetery, Mansfield, De Soto Parish, Louisiana.
 - l. **Mary Ada Permelia Howell** (11 Dec 1879–31 May 1939) married **James Robert Hamilton** (9 July 1874–18 Dec 1946), son of **William Parish Hamilton** (16 Oct 1843–16 Mar 1922) and **Sarah Ann Glover** (26 Jan 1848–23 July 1913). Ada and James Hamilton are buried in the Rockdale Cemetery, New Rockdale, De Soto Parish, Louisiana.
 - m. **Wiley Jefferson Howell** (12 June 1884–21 May 1947) married about 1907 to **Sarah Lou Smith** [Sallie] (2 Dec 1888–29 Dec 1948), daughter of **James C. Smith** (2 Feb 1856–17 May 1929) and **Elizabeth Hamilton** [Lizzie] (7 June 1866–12 Apr 1935). Wiley and Sarah are buried in the Rockdale Cemetery, New Rockdale, De Soto Parish, Louisiana.
5. **Rowan Amos Robinson** (10 Sept 1843–1843/1850).
- Family information states that Rowan Amos Robinson was a twin brother to Roana. He did not survive behind early childhood and had died by 1850.

♦ ♦ ♦ ♦ ♦ ♦

3. Sheny/Phiney Fowler

Sheny/Phiney Fowler (22 Jan 1816–after 1834) married on 28 December 1834 in Wilcox County, Alabama to **William Robeson/Robinson**. Only known probable child of Sheny/Phiney Fowler and William Robinson:

1. **William F. Robinson** (10 Feb 1836–?).

- This child's name was recorded on the second page of family information in the Fowler Bible. The births of Richard Fowler's other grandchildren followed William F. Robinson's entry. This indicates that William F. Robinson is likely another grandson of Richard and Sarah Fowler.
- No other information about William F. Robinson has been found.

♦ ♦ ♦ ♦ ♦

4. Milly Fowler

Milly Fowler (23 Dec 1817–1846/1847) married about 1842, probably in Wilcox County, Alabama, to **George Washington Albritton** (23 Oct 1810–28 Oct 1867), son of **Enoch Albritton** (1771–14 Feb 1834) and **Penelope Frizzle** (27 Jan 1772–after 1860). Known children of Milly Fowler and George Washington Albritton:

1. **Enoch Richard Albritton** (20 June 1843–2 July 1917) married on 14 January 1869 in Union Parish, Louisiana to **Elizabeth Virginia Taylor** [Eliza] (30 May 1848–16 Oct 1922), daughter of **Alexander M. Taylor** (13 Jan 1807–6 July 1861) and **Winifred Matthews** (4 Nov 1813–3 Mar 1872). Enoch and Eliza Albritton are buried in the Taylor/Liberty Hill Cemetery, Farmerville, Union Parish, Louisiana.
 - In the fall of 1861, Enoch R. Albritton initially joined the “*Stars of Equality*,” a unit formed by Hillory H. Ham consisting primarily of men from Farmerville. After traveling south to Camp Moore, Albritton enlisted with the men on 11 December 1861 as a private in Company E, 19th Regiment Louisiana Infantry. The day after their official entry into the service of the Confederate States Army, on December 12th, Capt. Ham signed a pass at Camp Moore for Enoch R. Albritton and several other soldiers,

Conduction of the Shreve Port and Texas Rail Road pass privates William Poer, W. B. Biass, Alexander Pardue, R. Coton, E. R. Albritton and J. H. W. Aulds of Company D of the 19th Regiment of Louisiana Volunteers from Desoto to Monroe and charge the same to the State of Louisiana.

[Compiled Military Service Record, Capt. Hillory H. Ham, Company E, 19th Regt. Louisiana Infantry]. It is unclear if there was a town by the name of “*Desoto*” at that time, but De Soto Parish was in northwestern Louisiana, and a trip there from Camp Moore (in southeastern Louisiana) could have necessitated a trip on the Shreveport-Texas Railroad. The purpose of the trip was not specified.
 - Enoch R. Albritton’s military record from the 19th Louisiana Regiment contains no information on his discharge from that unit. In fact, the only record is his enlistment. From his Louisiana Confederate pension application, he enlisted in the spring of 1863 at “*Old Trenton (near Monroe) La*” in Company D, 4th Louisiana Cavalry Regiment under Capt. W. R. Chambliss, although other records state the regiment did not form until January 1864 (perhaps his company formed earlier). This cavalry regiment operated in northeastern Louisiana and southern Arkansas in 1864 and 1865. Albritton said that at the surrender, he was “*At home on a furlough*.” On 21 March 1912, “*Ex-Capt.*” W. R. Chambliss wrote a letter stating that

This is to certify that E. R. Albritton was a member of my company at the close of the Civil War in good standing and if he is unable to make a decent living I know no reason why he should not receive a pension.

According to her Widow’s Confederate Pension Application dated 19 July 1917, Enoch Albritton and Eliza Taylor were married by Elder Bruton at her father’s home in Union Parish, Louisiana.

Known children of Enoch R. Albritton and Eliza Taylor:

- a. **Emma Albritton** (20 May 1870–30 Dec 1897). Emma was buried on 1 January 1898 in the Taylor/Liberty Hill Cemetery a few miles northeast of Farmerville, Union Parish, Louisiana.
 - The 1870 Federal Census records her name as “*Eliza*,” whereas the 1880 Federal Census, newspapers, and her tombstone give her name merely as “*Emma Albritton*.” It appears that the 1870 census enumerator made a mistake.
 - From Farmerville’s “*The Gazette*,” 24 November 1897, p. 3, column 1:

Miss Emma Albritton left Friday morning for Natchitoches, where she goes to enter the State Normal school.
 - From Farmerville’s “*The Gazette*,” 29 December 1897, p. 3, column 1:

Monday afternoon a telegram was received stating that Miss Emma Albritton, who is attending the State Normal school at Natchitoches, was dangerously ill. Her father, Mr. Enoch Albritton, accompanied by Dr. J. G. Taylor, left at once for her bedside.
 - From Farmerville’s “*The Gazette*,” 5 January 1898, p. 3, column 3:

After an illness of several days with slow fever Miss Emma Albritton, daughter of Mr. Enoch Albritton of this parish, died last Thursday afternoon at Natchitoches. Her father accompanied by Dr. J. G. Taylor reached her bedside the day prior to her death, in time to be recognized by his daughter. Miss Emma Albritton had laid aside a small sum of money by teaching for the past few years in the country schools of this parish, with which she intended to complete her education; but, alas! relentless death claimed her as his own and took her young life away. Her remains were brought to Farmerville Friday evening, and laid to rest Saturday in the Taylor cemetery near town. THE GAZETTE extends deep sympathy to the bereaved relatives and friends.
- b. **Mary E. Albritton** (4 Sept 1872–14 Mar 1876). Mary is buried in the Taylor/Liberty Hill Cemetery, Farmerville, Union Parish, Louisiana.

- c. **Alexander George Albritton** [Alex] (5 Mar 1874–14 Dec 1938) married on 24 December 1899 in Union Parish, Louisiana to **Florence C. Green** (11 July 1878–18 Apr 1956). Alex and Florence Albritton are buried in the Taylor/Liberty Hill Cemetery.
 - Florence married on 17 September 1893 in Union Parish, Louisiana to **George J. Arrant**.
 - d. **Ethel Mae Albritton** (3 Jan 1885–19 May 1968) is buried in the Taylor/Liberty Hill Cemetery.
 - e. [unknown] **Albritton**.
 - The 1900 census states that Elizabeth Virginia Taylor Albritton had given birth to a total of five children.
2. **James Andrew Albritton** (13 July 1846–1894) married on 22 April 1869 in Union Parish, Louisiana to **Elmince Catherine Hicks** [Elmina, Kittie] (16 Sept 1851–1937), daughter of **Elias A. Hicks** (c1827–after 1870) and **Elizabeth ?** (c1837–after 1870). Elmina Hicks Albritton is buried in the Mount Ida Cemetery near Mount Ida, Montgomery County, Arkansas.
- Some sources give James' middle name as "*Anderson*," but the Fowler Family Bible records his name as "*James Adrew Albritton*."
 - Family information gives her name as "*Kittie*." Her tombstone has her name as "*Elmina K. Albritton*," so her middle name may have been "*Katherine*." However, the death certificate of her son, Thomas, gives her name as "*Elmince Catherine Hicks*."
 - Data from descendants gathered in the 1950s and 1960s give Elmina's date of birth as 16 September 1851 and death as March 1937. However, the 1900 census lists her as born in December 1861 (the year is clearly a mistake, as she married in 1869).
 - James and Elmina lived in Union Parish in 1870 on his mother's farm. In the mid-1870s, they moved to Sevier County, Arkansas, where James died in 1894. His burial location is unknown.
 - In 1900, Elmina and her younger children lived on a rented farm in Saline Township, Sevier County, Arkansas. She had given birth to a total of seven children, only six of whom were then living. In 1910, she lived with her unmarried son, Thomas, on a rented farm in Sevier County.
 - In 1920, Elmina lived with her daughter, Mary Jane Albritton Sharrock, in Eagle Township, McCurtain County Oklahoma. In 1930, she lived with her daughter, Elizabeth R. Albritton McCullar, in Montgomery County, Arkansas.

Known children of James Andrew Albritton and Elmina Hicks:

- a. **George Anderson Albritton** (15 Mar 1870–c1888) died in Cerregordia, Sevier County, Arkansas.
 - The Fowler Family Bible records this entry immediately following the entry for James Andrew Albritton: "*George Anderson Albritton was born march [sic] the 15 1870.*"
 - The 1870 census listed his name as "*Anderson C. Albritton*," but the 1880 census recorded him as "*George Albritton*."
- b. **Elizabeth Roann Albritton** [Eliza] (22 Mar 1872–19 Jan 1962) married on 27 December 1894 in Sevier County, Arkansas to **Sidney Joseph McCullar** (17 Mar 1871–1946), son of **Benjamin Franklin McCullar** and **Mary Elizabeth Amerson**. Mary Jane and Sidney McCullar are buried in the Mount Ida Cemetery, Mount Ida, Montgomery County, Arkansas.
 - The Fowler Family Bible records this entry after that of George Anderson Albritton: "*Eliza Roann Albritton was born march [sic] the 22 1872.*" The Bible only recorded the births of the first two children of James Andrew Albritton, presumably because after Eliza's birth, he moved his family to Sevier County, Arkansas.
- c. **James Francis Albritton** (14 July 1875–1935) married on 28 November 1907 in Sevier County, Arkansas to **Mary Susan Smith** [Susie] (23 Jan 1887–27 Oct 1971). James Albritton is buried in the Pauley Cemetery near Cerrogordo, Little River County, Arkansas. Susie died in Upland, San Bernardino County, California.
- d. **Mary Jane Albritton** (20 Dec 1877–30 June 1964) married **Thomas Harmon Sharrock** (19 Mar 1877–5 Apr 1959). Mary Jane and Thomas Sharrock are buried in the Broken Bow Cemetery, Broken Bow, McCurtain County, Oklahoma.
- e. **Thomas Allen Albritton, Sr.** [Tom, Tommy] (19 Aug 1880–20 July 1973) married on 26 February 1916 to **Eathel Lennie Pemberton** (21 Jan 1896–14 Nov 1975). Thomas and Eathel Albritton are buried in the Jamestown Cemetery, Smith County, Texas.
 - Thomas remained single until the late 1910s. In 1910, he lived with his mother in Sevier County, Arkansas. In 1920, he and his wife lived near his mother and sister in McCurtain County Oklahoma. In 1930, Thomas and his family lived in Smith County, Texas.
- f. **Jocie Arnett Albritton** [Josy, Josie] (15 Apr 1884–5 Aug 1966) married on 11 November 1904 in Sevier County, Arkansas to **Joseph Bigham** [Joe] (2 Mar 1883–26 Feb 1941). Josie and Joe Bigham are buried in the Buttram Chapel Cemetery near Pea Ridge, Benton County, Arkansas.

g. **John Washington Albritton** (12 May 1886–2 May 1974) married on 25 April 1909 in Sevier County, Arkansas to **Mary Emma Ridley** (25 Aug 1894–17 Dec 1992). John and Mary Albritton are buried in the Belcrest Memorial Park Cemetery, Salem, Marion County Oregon, Plot Block 44.

- John lived with his widowed mother in 1900 and with his new wife in 1910, both in Sevier County, Arkansas.
- In 1920, John and Mary and their children lived in Choctaw County Oklahoma. By 1930, they had moved to Hall County, Texas with their children **Homer F. Albritton** (born c1912), **Dona M. Albritton** (born c1913), and **Cecil Willie Albritton** (born 26 Aug 1915).
- John and Mary moved with their family to Oregon in the 1930s. In 1940, they lived in Polk County, Oregon.

♦ ♦ ♦ ♦ ♦ ♦

5. Samantha Fowler

Samantha Fowler [Mantha, Manthy] (19 Nov 1819–28 Nov 1905) married on 5 November 1837 in Wilcox County, Alabama to **Noah Lewis Scarborough** (c1808–1881/1882), son of **Addison Scarborough** (c1780–1868). Samantha and Noah are buried in the Taylor/Liberty Hill Cemetery near their old farm, several miles east of Farmerville, Union Parish, Louisiana. Known children of Samantha Fowler and Noah Scarborough:

1. **Sarah Ann Elizabeth Scarborough** [Betsy] (3 Sept 1838–25 Mar 1914) [Betsy] married on 28 July 1854 in Union Parish, Louisiana to **John Thomas Ward** [Jack] (30 June 1835–30 Dec 1883), the son of **David Ward** (c1806–4 May 1882) and **Cynthia Seale** (c1812–27 Mar 1857). Betsy and Jack are buried in the Ward's Chapel Cemetery in Union Parish, Louisiana.

Children of Betsy Scarborough and Jack Ward:

- a. **John David Ward** (c1855–1860/1870).
 - b. **James Addison Ward** (7 Apr 1856–26 Dec 1926) married 9 December 1877 in Ouachita Parish, Louisiana to **Nancy McGough** (12 Dec 1859–20 Aug 1933). James and Nancy Ward are buried in the Liberty Hill/Taylor Cemetery, Farmerville, Union Parish, Louisiana.
 - c. **Sarah Ann Elizabeth Ward** (1 Apr 1858–2 Nov 1923) married on 23 December 1880 in Union Parish, Louisiana to **Robert Armstrong McGough** (1 May 1854–3 Oct 1908). Sarah and Robert are buried in the Liberty Hill/Taylor Cemetery, Farmerville, Union Parish, Louisiana.
 - d. **Mary Ann Ward** (16 Apr 1860–10 Feb 1942) married 29 June 1880 in Union Parish, Louisiana, to **Benjamin Allen Taylor** (25 June 1861–1 Mar 1907). Mary Ann and Benjamin are buried in the Liberty Hill/Taylor Cemetery, Farmerville, Union Parish, Louisiana.
 - e. **Cynthia Jane Ward** (23 Sept 1864–8 Oct 1926) married 29 February 1888 in Union Parish, Louisiana to **Jessie Wilkie Brantley, Sr.** (4 Oct 1849–9 June 1891), son of **Jesse Brantley** (c1827–May 1849) and **Elizabeth Tutt** (27 Oct 1820–1870/1880). Janie Ward Brantley is buried in the Taylor/Liberty Hill Cemetery, Farmerville, and Jessie Wilkie Brantley is buried in the Edwards Family Cemetery, Marion, both in Union Parish, Louisiana.
 - f. **Matthew T. Ward** (c1869–Mar 1870) died of whooping cough.
 - g. **Henry Jefferson Ward** (1870–15 Jan 1898) married on 11 February 1892 in Union Parish, Louisiana to **Johnnie G. Rabun** (1871–1961). Henry and Johnnie Rabun Ward are buried in the Ward's Chapel Cemetery, Farmerville, Union Parish, Louisiana.
 - h. **George Allen Ward** (13 May 1874–11 May 1938) married about 1905 in Union Parish, Louisiana to the widow **Mary Elizabeth Smith Dean** (2 Mar 1878–20 July 1949). George and Mary are buried in the Liberty Hill/Taylor Cemetery, Farmerville, Union Parish, Louisiana.
 - i. **Nancy Theodocia Ward** [Docia] (8 Mar 1878–14 Mar 1950) married on 6 January 1897 in Union Parish, Louisiana to **Charles Henry Hudson** (16 Dec 1873–24 May 1957). Docia died in a Monroe, Ouachita Parish, Louisiana hospital. Docia and Charles are buried in the Liberty Hill/Taylor Cemetery, Farmerville, Union Parish, Louisiana.
 - j. **[infant] Ward**, probably born in the 1860s or 1870s.
2. **Mary Ann Scarborough** (20 Feb 1840–27 Dec 1895) married on 22 April 1858 in Union Parish, Louisiana to **David Ward Solomon** (21 July 1834–22 Jan 1876), the son of **George Washington Solomon** (12 Oct 1807–28 Mar 1863) and **Elizabeth J. Ward** (20 Feb 1810–26 Nov 1886). Mary Ann Scarborough Solomon married 1876–1880 in Freestone County, Texas to **Spaulding Moore** (c1811–after 1880).

Known children of Mary Ann Scarborough and David Ward Solomon include:

- a. [infant male] **Solomon** (about Apr 1859–Oct 1859) died at six months of age.
- b. **David Ward Solomon** (30 Aug 1864–6 Apr 1947) married on 19 September 1897 in Freestone County Texas to **Dollie Stillman** (19 Sept 1874 – 3 July 1952), the daughter of **J. J. Stillman** and **Martha Hanna Nutt** (10 Apr 1852–27 Sept 1918). David W. Solomon is buried in the Snyder Cemetery, Snyder, Scurry County Texas. Dollie is buried in the Shannon Rose Hill Memorial Park, Fort Worth, Tarrant County Texas, Lakeview Section.
- c. **George Noah Solomon** (4 June 1866–11 May 1954) married on 5 January 1892 in Freestone County, Texas to **Mary A. Graham**. George married on 16 November 1896 in Freestone County, Texas to **Delia Elizabeth Richardson** (16 Nov 1876–24 Jan 1960), daughter of **John Whitney Richardson** (27 Aug 1849–8 Oct 1924) and **Mary Louise Cobbs** (14 Apr 1853–13 Mar 1936). George and Delia are buried in the Colorado City Cemetery, Colorado City, Mitchell County, Texas, Plots LW-46-11.

- d. **Lou Ella Solomon** [Louella] (12/14 Feb 1875–27 June 1966) married on 12 November 1896 in Freestone County, Texas to **William Ross Gilpin** (6 Apr 1862–25 Jan 1899), son of **Richmand Gilpin** (1828–1878) and **Sarah Elizabeth Jones** (1840–1871). Lou Ella married about 1904, presumably in Texas, to **Walton Zealous H. East** (16 Aug 1876–18 Feb 1920), son of **Elias East** (14 Aug 1840–11 Dec 1923) and **F. A. Cornette Pool** (15 Aug 1840–22 May 1898). Lou Ella married on 15 February 1939 in Mitchell County, Texas to **Hall Bruce DeGarmo** (13 Feb 1872–14 Sept 1956). William Ross Gilpin is buried in the Harrison Chapel Cemetery near Dew, Freestone County, Texas, together with their infant son. Lou Ella and Walton are buried in the Armour Cemetery with their infant daughter near Coolidge, Limestone County, Texas.
3. **Samantha Elvyann Scarborough** (15 Sep 1842–6 Apr 1922) married on 15 November 1860 in Union Parish, Louisiana to **Hillory Herbert Ham (Sr.)** (c1828–12 Apr 1889), the son of **William Ham** (c1801–1867) and **Clarenda Seale** (Nov 1811–30 May 1897). Samantha and Hillory divorced on 18 March 1876. She is buried in the Liberty Hill/Taylor Cemetery, he in the Ward's Chapel Cemetery.

Known children of Samantha E. Scarborough and Hillory H. Ham:

- a. **Matthew Addison Ham** [Dick] (Dec 1861–23 Mar 1930) married on 9 April 1885 in Union Parish, Louisiana to **Henrietta Jane Russell** [Helen, Etta, Jennie, Janie] (19 Mar 1868–9 Mar 1942), daughter of **John W. Russell** (15 Oct 1834–26 Jan 1893). Matthew and Janie Ham are buried in the Taylor/Liberty Hill Cemetery near Farmerville, Union Parish, Louisiana.
 - b. **Nancy Alice Ham** (Mar 1863–1910) married 8 January 1880 in Union Parish, Louisiana to **William Jackson Roan** (1 Dec 1859–26 May 1904), the son of **Elijah Roan** (1826–14 Nov 1895) and **Sarah Elizabeth Rabun** (1840–Feb 1912). Nancy and William Roan are buried in the Taylor/Liberty Hill Cemetery, Farmerville, Union Parish, Louisiana.
 - c. **William J. Ham** (Oct 1865–after 1900) was single in 1900.
 - d. **Mary T. Anna Ham** [Anna, Mittie] (Nov 1867–13 Dec 1900) married on 7 April 1884 in Union Parish, Louisiana to **William Pinckney Boatright** [Will] (10 Nov 1857–8 Feb 1901), son of **James Boatright** (1821/1822–29 Nov 1862) and **Jane Elizabeth Stiles** (c1824–1/5 Aug 1896). Anna and Will Boatright are buried in the Hamburg Cemetery, Hamburg, Ashley County, Arkansas.
 - e. **Henry Regenburg Ham** (6 Aug 1868–17 May 1947) married on 28 May 1896 in Union Parish, Louisiana to **Daisy A. Elkins** (21 Apr 1878–28 July 1946), the daughter of **John William Elkins** (19 Aug 1846–24 July 1925) and **Josephine Freeman** (1848–16 Dec 1933). Henry and Daisy divorced, and Henry married on 27 April 1902 in Union Parish, Louisiana to **Betty Gertrude Towns** (19 Feb 1882–23 Apr 1957), daughter of **Richard Gideon Towns** (22 Dec 1849–20 Apr 1922) and **Frances Jane Walker** (7 Oct 1855–3 Jan 1936). Henry and Betty Ham are buried in the Union-Sadie Cemetery, Sadie, Union Parish, Louisiana. Daisy Elkins Skates is buried in the Hasley Cemetery, West Monroe, Ouachita Parish, Louisiana.
 - f. **John Hubbard Ham** (14 Mar 1870–2 Jan 1913) married on 19 December 1895 in Union Parish, Louisiana to **Lillie Saphronia Elkins** (4 Mar 1876–2 Nov 1911), the daughter of **John William Elkins** (19 Aug 1846–24 July 1925) and **Josephine Freeman** (1848–16 Dec 1933). Lillie Elkins Ham is buried in the Mount Nebo Cemetery, eight miles south of Farmerville, Union Parish, Louisiana. John died in Ouachita Parish and is buried in the Drew Cemetery near West Monroe, Ouachita Parish, Louisiana.
 - g. **Bettie Ham** (c1872–after 1880) lived with her mother in 1880. It is not known if she died young or married.
 - h. **Rosa Etta Ham** [Rosie] (June 1874–7 Dec 1934) married in Union Parish, Louisiana on 29 December 1901 to **Amos G. McLemore** (24 Nov 1856–28 Sept 1927), son of **John M. McLemore** (c1830–after 1880) and **Susannah Vick** (15 Jan 1829–30 Dec 1903). Rosa and Amos are buried in the Riverview Cemetery in Monroe, Ouachita Parish, Louisiana. Amos has a tombstone, but Rosa's grave is unmarked.
 - i. [unknown] **Ham**.
 - Since Elvyann was listed as the mother of nine children in 1910, she and Hillory apparently had a child who presumably died as an infant or youth.
4. **Susan Malissa Scarborough** (6 Nov 1844–12 Dec 1937) married on 28 March 1867 in Union Parish, Louisiana to **George Noah Scarborough** (14 Oct 1844–31 Oct 1928), her first cousin, son of **Simeon R. Scarborough** [Sim] (c1805–1874/1876) and **Mary Emily/Eunice Moseley** (c1811–after 1860).

Known children of Susan Malissa and George Scarborough, all buried in the Taylor/Liberty Hill Cemetery, Farmerville, Union Parish, Louisiana:

- a. **John Charles Henry Scarborough** (12 Feb 1868–15 Nov 1921) married on 29 October 1891 in Union Parish, Louisiana to **Melissa Elizabeth Jordan** [Lizzie] (Oct 1863–22 May 1930), the daughter of **Samuel Jordan** and **Frances Reagan**.

- b. **Mary Samantha Scarborough** [Mollie] (19 Mar 1870–27 Mar 1924) married on 23 January 1890 in Union Parish, Louisiana to **Ellen Burrough Edwards** (22 Dec 1869–25 Oct 1937), son of **Miller Bledsoe Edwards** (8 Nov 1813–5 Mar 1897) and **Mahalia Bilberry** (27 Oct 1829–15 Oct 1911).
 - c. **Matthew Addison Scarborough** (12 Oct 1872–30 Oct 1888).
 - d. **George Elliott Scarborough** (7 Dec 1878–30 Apr 1958) married on 15 December 1901 in Union Parish, Louisiana to **Mae Hill** [May, Minnie] (1880–24 Jan 1963).
 - e. **Stella M. Scarborough** (30 May 1881–22 Nov 1901).
5. **Nancy L. Scarborough** (17 Oct 1846–13 Aug 1939) married on 20 February 1868 in Union Parish, Louisiana to **William Henry Harrison Ward** (25 Apr 1848–1869/1870), son of **David Ward** (c1806–4 May 1882) and **Cynthia Seale** (c1812–27 Mar 1857). Nancy married on 21 December 1882 in Union Parish to **Francis Marion Roan** (21 Jan 1858–13 Feb 1928), son of **Peyton Roan** (c1825–1873/1878) and **Leander Isabella Spigener** [Lena] (c1837–after 1900). Nancy died in Ouachita Parish, but is buried in the Rocky Branch Cemetery in Union Parish.

Child of Nancy L. Scarborough and William H. H. Ward:

- a. **William Henry Ward** born and died within one week in March 1870 of “*Whoping Cough*.”

Known children of Nancy L. Scarborough and Francis Marion Roan:

- b. **Frances Etta Roan** [Ginnie] (11 July 1886–28 July 1969) married about 1907 to **Lawrence Randolph Pace** (15 Oct 1883–15 Feb 1911), the son of **Robert Dempsey Pace** (30 Jan 1855–3 Apr 1941) and **Samantha Jane Livingston** (26 Mar 1961–3 Apr 1935). Etta married in the 1920s, probably in Ouachita Parish, Louisiana, to **Herbert S. Simmons** (Aug 1881–8 June 1936). Etta and Lawrence are buried in the Rocky Branch Cemetery. Herbert is buried in the Farmerville Cemetery, Farmerville, Union Parish, Louisiana.
- c. **Susan Roan** [Susie] (Apr 1890–after 1900) lived with her parents in 1900.

Adopted daughter of Nancy Scarborough and Francis Marion Roan:

- d. **Elizabeth Roan** [Lizzie] (c1899 – after 1969).

6. **Matthew Addison Scarborough** (4 June 1850–19 Mar 1931) married on 18 June 1873 in Union Parish, Louisiana to **Clarenda Jane Ham** (25 Oct 1854–23 July 1902), daughter of **Hillory Herbert Ham (Sr.)** (c1828–12 Apr 1889) and **Isabella Ann Robinson** (15 Sept 1828–28 May 1860). Matt Scarborough is buried in the Carlsbad Cemetery, Carlsbad, Eddy County New Mexico, Plot Div B-Blk5-Lot 8. Janie Ham Scarborough is buried in the Taylor/Liberty Hill Cemetery near Farmerville, Union Parish, Louisiana

Children of Matthew Addison Scarborough and Clarenda Jane Ham:

- a. **Dona Isabella Scarborough** (23 July 1874–9 Oct 1876).
 - b. **Udora Scarborough** (16 Jan 1876–9 Mar 1879) died of croup.
 - c. **Ada May Scarborough** (5 Sept 1877–31 Jan 1879).
 - d. **Simeon Climon Scarborough** [Bud] (5 Feb 1880–2 Aug 1953) remained single and is buried in the Carlsbad Cemetery, Carlsbad, Eddy County New Mexico.
 - e. **Mattie Jane Scarborough** (22 Sept 1881–2 Apr 1902) is buried in the Taylor/Liberty Hill Cemetery near Farmerville.
 - f. **Samantha Ethel Scarborough** (17 Feb 1885–3 Feb 1925) remained single and is buried in the Carlsbad Cemetery, Carlsbad, Eddy County New Mexico.
 - g. **George Noah Scarborough** (17 Feb 1885–19 Feb 1885) was a twin to Samantha Ethel.
 - h. **Linnie Mae Scarborough** (31 Jan 1887–7 July 1969) married on 26 February 1905 in Union Parish, Louisiana to **Ambrose B. Cole** (1 Feb 1883–16 Dec 1931), the son of **William Meeks Cole** (10 Mar 1845–28 Jan 1929) and **Caroline Webster Morris** [Webb] (9 Aug 1852–22 Nov 1906). Linnie and Ambrose Cole are buried in the Carlsbad Cemetery, Carlsbad, Eddy County New Mexico.
 - i. **Lillian Scarborough** (31 Mar 1889–25 Nov 1922) remained single and is buried in the Carlsbad Cemetery, Carlsbad, Eddy County New Mexico.
 - j. **Mary Hollan Scarborough** (15 Mar 1892–8 July 1892).
 - k. infant male (19 July 1893–21 July 1893).
 - l. **Elma Clara Scarborough** (1 May 1895–9 Nov 1964) remained single and is buried in the Carlsbad Cemetery, Carlsbad, Eddy County New Mexico.
7. **Frances Rhoyan Scarborough** (4 May 1853–14 Oct 1940) married on 7 Sept 1871 in Union Parish, Louisiana to **James Jasper Flowers** [Dick] (5 Jan 1847–17 Oct 1930), the son of **Jacob Flowers** and **Elizabeth M. ?**. Rhoyan and Dick Flowers are buried in the Liberty Hill/Taylor Cemetery.

Children of Frances Rhoyan Scarborough and James Jasper Flowers:

- a. **Ollie Zelious Flowers** (1878–1879) is buried in the Liberty Hill/Taylor Cemetery.
 - b. **Samantha Elizabeth Flowers** [Sittie] (22 Nov 1879–31 Aug 1972) never married and is buried in the Liberty Hill/Taylor Cemetery.
 - c. **Mary Emma Flowers** (27 Apr 1883–3 Aug 1963) married on 4 April 1903 in Union Parish, Louisiana to **Aubrey Rabun** (Feb 1883–1910/1920), the son of **William H. Rabun** and **Ann S. Freeman**. Emma is buried in the Liberty Hill/Taylor Cemetery, Farmerville, Union Parish, Louisiana.
 - d. **Josie Etta Flowers** (18 May 1886–1 June 1965) married on 25 December 1904, probably in Ouachita Parish, Louisiana, to **William Marion Pace** (14 Sept 1885–27 Dec 1970), son of **Robert Dempsey Pace** (30 Jan 1855–3 Apr 1941) and **Samantha Jane Livingston** (26 Mar 1961–3 Apr 1935). Josie and William are buried in the Rocky Branch Cemetery, Union Parish, Louisiana.
 - e. infant **Flowers** (1886–1886) is buried in the Liberty Hill/Taylor Cemetery.
 - f. **James Matthew Flowers** (Apr 1888–1905) is buried in the Liberty Hill/Taylor Cemetery.
8. **S. Jane Scarborough** (c1855–1860/1870) died young without leaving heirs.
9. **Emma Theodosia Scarborough** [Dosia] (28 May 1857–21 Oct 1945) married about 1875 to **William Neavil Miller** (9 Nov 1855–2 Oct 1905), son of **Peter Smith Miller** (10 Aug 1811–20 Aug 1861) and **Elizabeth Smith** (2 Sept 1810–27 Feb 1880).

Children of Dosia and William Miller:

- a. **Dawsey Miller** (c1879–1880/1900) lived with his parents in Ouachita Parish in 1880, but he must have died soon afterwards.
- b. **George Walter Miller** (5 Nov 1883–17 Aug 1969) married on 4 January 1903 in Union Parish, Louisiana to **Sarah E. Wheeler** [Sallie] (7 July 1886–21 Nov 1924). Walter Miller married on 1 October 1925 in Union Parish to **Ophelia Hodge Newcomb** (15 Feb 1888–26 July 1927), daughter of **Alonzo Walter Hodge** [Lon] (8 Aug 1868–23 Nov 1941) and **Ida Rayner** (11 Nov 1873–25 July 1911). Walter married in late August 1929 to **Minnie Odessa Slade Ward** (24 Mar 1894–12 Apr 1983), the daughter of **James Jethro Slade** (14 Apr 1862–23 Dec 1932) and **Lou Exar Montgomery** (13 Nov 1867–17 Jan 1935). Walter and Sarah Miller are buried in the Marion Baptist Church Cemetery, Marion. Ophelia Hodge Newcomb Miller is buried in the Concord Cemetery, Marion. Odessa Slade Ward Miller is buried in the Taylor/Liberty Hill Cemetery, Farmerville, all located in Union Parish, Louisiana.
- c. **John Leonard Miller** [J.L.] (15 Mar 1886–18 Jan 1959) married about November 1909 to **Gordie Lee Toler** (1 Feb 1895–4 Sept 1991), daughter of **John A. Toler** (11 Feb 1862–11 July 1939) and **Mary Virginia Oliver** (5 Mar 1866–6 Sept 1932). Leonard and Cordie Miller are buried in the Concord Cemetery, Marion, Union Parish, Louisiana.
- d. **Alma M. Miller** (29 Dec 1889–23 Oct 1939) married on 14 August 1907 in Union Parish, Louisiana to **John Comer Peek** (23 Sept 1879–9 Jan 1945), the son of **J. E. Peek** and **Mary M. ?** (5 Sept 1837–26 Feb 1906). Alma and John are buried in the Concord Cemetery, Marion, Union Parish, Louisiana.
- e. **Joseph William Miller** [Joe] (2 Feb 1891–5 Oct 1976) married about 1915 to **Martha Alice Holloway** [Mattie] (16 Sept 1895–13 Nov 1969), daughter of **Thomas Lewis Holloway** (12 Oct 1852–4 Feb 1930) and **Mariah Jane Hopkins** (27 Mar 1858–29 Oct 1937). Joe and Mattie Miller are buried in the Mulhearn Memorial Park Cemetery, Monroe, Ouachita Parish, Louisiana, Ridgecrest Plot.
- f. **Frances Ruth Miller** [Fannie] (6 Nov 1897–23 May 1987) married on 24 July 1912 in Union Parish, Louisiana to **James Edward Crow** [Ed] (12 Mar 1894–14 Aug 1961), the son of **William Marion Crow** (7 Feb 1844–23 Nov 1927) and **Alice Jane Cooper** (15 Mar 1853–20 Nov 1906). Ruth and James are buried in the Taylor/Liberty Hill Cemetery, Farmerville, Union Parish, Louisiana.
- g. [unknown] **Miller** (born/died 1876/1900).

♦ ♦ ♦ ♦ ♦

6. Sarah Ann Fowler

Sarah Ann Fowler (22 Aug 1823–4 Oct 1875) married on 3 January 1850 in Wilcox County, Alabama to **George Washington Albritton** (23 Oct 1810–28 Oct 1867), son of **Enoch Albritton** (1771–14 Feb 1834) and **Penelope Frizzle** (27 Jan 1772–after 1860). Sarah Ann and George W. Albritton are buried in the Taylor/Liberty Hill Cemetery, Farmerville, Union Parish, Louisiana. Known children of Sarah Ann Fowler and George Washington Albritton:

1. **Rebecca Frances Albritton** (1 Nov 1850–6 Mar 1935) married in April 1875 in Union Parish, Louisiana to **Thomas Allen Dean** (29 Apr 1851–2 Aug 1924), son of **Josiah Deanes** (c1800–8 Oct 1851) and **Sarah Ann Taylor** (1808/1811–1870/1880). Rebecca and Tom Dean are buried in the Taylor/Liberty Hill Cemetery, Farmerville, Union Parish, Louisiana.

Children of Rebecca F. Albritton and Thomas A. Dean, all buried in the Taylor/Liberty Hill Cemetery, Farmerville, Union Parish, Louisiana:

- a. **Joseph Washington Dean** [Joe] (4 Mar 1876–5 Jan 1959) married on 21 January 1897 in Union Parish, Louisiana to **Mary Emily Purdy** (9 May 1877–29 June 1965), daughter of **James Benton Purdy** (Aug 1848–15 Jan 1926) and **Emily Octavia Boatright** (c1851–1884/1885).
 - b. **Thomas Birtum Dean** [Bert] (16 Aug 1877–3 Aug 1961) is buried beside his parents.
 - c. **Sallie May Dean** (20 May 1879–5 Nov 1930) is buried beside her parents.
 - d. **Caray Etta Dean** (5 July 1881–20 June 1925) married on 6 January 1905 in Union Parish, Louisiana to **Grover Cleveland Sharrock** [Pete] (Jan 1884–28 Sept 1905).
 - e. **Addie Pearl Dean** (7 Aug 1884–20 June 1936) married on 2 March 1902 to **Stephen Thomas Goynes** (15 Feb 1878–31 July 1952), son of **John Saxton Goynes** (Feb 1857–c1918) and **Sammie Luginia Rabun** (c1857–12 Jan 1925).
 - f. **Elizabeth Dean** [Lizzie] (24 Nov 1885–20 Jan 1959) married on 22 Jan 1912 in Union Parish, Louisiana to **George William Boatright** (6 Sept 1886–24 Dec 1934), son of **William Pinckney Boatright** (10 Nov 1857–8 Feb 1901) and **Mary T. Anna Ham** (Nov 1867–13 Dec 1900).
 - g. [unnamed] **Dean** died as an infant at birth.
 - h. **George Washington Dean** (21 Dec 1888–1 Nov 1974) married on 22 Dec 1912 in Union Parish, Louisiana to **Exa Odom** (13 Nov 1892–31 Oct 1981), daughter of **James Benjamin Odom, Jr.** (1 Mar 1857–18 Oct 1936) and **Sopharona Tubb** (16 Apr 1865–4 Jan 1909).
 - i. **Eunice Dean** (20 Mar 1891–20 May 1920) married on 31 December 1917 in Union Parish, Louisiana to **Robert Horace McGough** (15 June 1889–1 Jan 1923), the son of **Robert Armstrong McGough** (1 May 1854–3 Oct 1908) and **Sarah Ann Elizabeth Ward** (1 Apr 1858–2 Nov 1923).
 - j. **Emma Rebecca Dean** (6 May 1893–16 June 1983) married on 22 December 1912 in Union Parish, Louisiana to **Otis Gray Hicks** (13 Aug 1888–15 June 1969), the son of **Leon H. Hicks** (25 Oct 1858–19 Sept 1929) and **Sarah Docia McGough** [Sallie] (Jan 1861–1921).
2. **Georgia Ann Albritton** (31 Dec 1853–18 Oct 1930) married on 7 November 1870 in Union Parish, Louisiana to **John L. Rabun** (1845–1871), the son of **John Rabun** (c1812–Jan 1860) and **Catherine Taylor** (c1819–after 1880). Georgia married on 9 August 1877 in Union Parish, Louisiana to **William Booth** (25 Aug 1855–16 Dec 1929), son of **Zachariah A. Booth** (15 Sept 1829–Dec 1904) and **Sedonia A. Brantley** (Jan 1837–Mar 1904). Georgia and William Booth are buried in the Taylor/Liberty Hill Cemetery, Farmerville, Union Parish, Louisiana.

Known child of Georgia Ann Albritton and John L. Rabun.

- a. **Johnnie J. Rabun** (15 Aug 1871–19 Nov 1961) married on 11 February 1892 in Union Parish, Louisiana to **Henry Jefferson Ward** (1870–15 Jan 1898), the son of **John Thomas Ward** (30 June 1835–30 Dec 1883) and **Sarah Ann Elizabeth Scarborough** (3 Sept 1838–25 Mar 1914). Johnnie married on 12 December 1901 in Union Parish, Louisiana to **Jasper N. Harrell** (25 May 1873–1 June 1944). Johnnie and Henry Jeff Ward are buried together in the Ward's Chapel Cemetery near Farmerville, and Jasper Harrell is buried Liberty Baptist Cemetery near Linville, both in Union Parish, Louisiana.
 - Johnnie's death certificate gave her birthdate as 15 August 1871 and date of death as 19 November 1961. She died in Winnsboro, Franklin Parish, Louisiana.
 - On her marriage record to Harrell in 1901 (Union Parish LA Marriage Book 10, p. 322), she signed her name as "Johnnie Ward." Witnesses to the marriage were her stepfather, A. D. Crow, and E. B. Harrell.
 - Jasper N. Harrell died in Caldwell Parish.

Known children of Georgia Ann Albritton and William Booth:

- b. **Sarah Sedonia Booth** (31 July 1878–12 Dec 1879) is buried in the Liberty Cemetery near Marion, Union Parish, Louisiana.
 - Sarah Sedonia Booth has a double marker with her sister, Metta Booth.
 - c. **Elora Booth** [Lora] (3 Feb 1880–3 Feb 1926) married on 8 November 1904 in Union Parish, Louisiana to **Leander A. Nolan** (6 Mar 1878–14 Sept 1957), the son of **William Henry Clay Nolan** (12 Dec 1846–25 July 1921) and **Melissa Ann Hendrick** (5 Apr 1846–14 Mar 1926). Lora and Leander Nolan are buried in the Taylor/Liberty Hill Cemetery.
 - d. **Metta Booth** (4 June 1882–3 Sept 1884) is buried in the Liberty Cemetery near Marion, Union Parish, Louisiana.
 - Metta has a double marker with her sister, Sarah Seconia Booth.
 - e. **Joseph William Booth** [Joe] (7 Sept 1885–28 Sept 1952) married on 23 September 1914 to **Sudie Lavanda Pickens** (7 Mar 1886–5 Nov 1967). Joseph and Sudie are buried in the Farmerville Cemetery.
 - f. **Georgia Elizabeth Booth** (12 Jan 1888–15 Jan 1945) married on 23 July 1905 to **Benjamin Franklin Stewart** (30 Apr 1886–30 Apr 1957). Georgia is buried in the Taylor/Liberty Hill Cemetery.
 - g. **Jones Matthew Booth** (23 Mar 1890–3 Feb 1967) married on 13 May 1914 in Union Parish, Louisiana to **Annie Preus** (6 Oct 1889–27 Jan 1968), daughter of **Frederick F. Preaus** (17 Aug 1853–11 Sept 1911) and **Anna Buce** (7 Oct 1866–17 Apr 1933). Jones and Annie are buried in the Farmerville Cemetery.
 - h. **Alonzo Clifton Booth** [Lonza, Lon] (4 Mar 1892–18 Mar 1973) married 1 January 1922 to **Caribel Shaw** (3 Mar 1898–Dec 1988), daughter of **C. O. Shaw** and **Martha Sophia Stafford**. Lon and Caribel are buried in the El Reno Cemetery in El Reno, Canadian County Oklahoma.
 - Lon served as a corporal in the United States Army during World War I.
 - i. **Zachariah R. Booth** (16 July 1895–18 Sept 1968) married on 14 November 1917 to **Clara Miller** (6 Nov 1898–5 Feb 1998), daughter of **Peter Leonard Miller** (6 Aug 1871–15 Aug 1963) and **Sarah Brantley** [Sallie] (2 Sept 1874–8 Feb 1901). Zach and Clara are buried in the Taylor/Liberty Hill Cemetery.
3. **A. W. Albritton** [male] (c1855–1860/1867).
4. **William Arnett Albritton** (28 Nov 1856–29/30 Mar 1927) married on 23 July 1879 in Union Parish, Louisiana to **Sarah Catherine Taylor** [Sallie] (2 Nov 1863–21 Dec 1928), daughter of **John D. Taylor** (12 May 1834–1896) and **Sarah Matilda Stancil** (28 Jan 1837 - ?). William and Sarah Albritton are buried in the Taylor/Liberty Hill Cemetery.

Known children of William and Sallie Taylor Albritton:

- a. **George Allen Albritton** (2 Apr 1881–4 Nov 1927) married on 11 November 1900 in Union Parish, Louisiana to **Minnie Lou Ham** (3 Feb 1882–5 Sept 1960), daughter of **Hillory Herbert Ham, Jr.** [Hub, H. Hub] (3 Sept 1834–16 Mar 1889) and **Minnie F. Jordan** (10 Nov 1857–4 Feb 1905). George is buried in the Taylor/Liberty Hill Cemetery, Farmerville, Union Parish, Louisiana. Minnie Lou Ham Feist is buried in the Forest Park Cemetery, Houston, Harris County, Texas, Section 31 Sunnyside, with two of their sons.
- b. **Mattie Rosetta Albritton** (25 July 1882–17 Nov 1925) married on 11 January 1899 in Union Parish, Louisiana to **William David Cole** (12 Nov 1876–10 July 1921), the son of **William Meek Cole** (10 Mar 1845–28 Jan 1929) and **Caroline Webster Morris** (9 Aug 1852–22 Nov 1906). Mattie and William are buried in the Taylor/Liberty Hill Cemetery, Farmerville, Union Parish, Louisiana.
- c. **Elizabeth Gertrude Albritton** (15 May 1884–16 Dec 1951) married on 8 August 1900 in Union Parish, Louisiana to **Robert Lee Kennedy** (1880–1920), the son of **John Wilson Kennedy, Sr.** (3 May 1849–23 Sept 1913) and **Elizabeth McGough**. Elizabeth and Robert are buried in the Taylor/Liberty Hill Cemetery, Farmerville, Union Parish, Louisiana.
- d. **Charles Henry Albritton, Sr.** [Charlie] (28 Aug 1885–10 Sept 1953) married on 11 November 1905 in Union Parish, Louisiana to **Frances Nettie Edwards** [Fannie] (4 July 1888–13 Sept 1980), daughter of **George Washington Edwards** (5 Jan 1856–23 Mar 1947) and **Bettie Serena Miller** (13 Apr 1866–17 Oct 1958). Charlie and Bettie are buried in the Taylor/Liberty Hill Cemetery, Farmerville, Union Parish, Louisiana.
- e. **Jesse William Albritton** (1 Feb 1888–14 Jan 1944) married on 18 January 1911 in Union Parish, Louisiana to **Annie G. Hicks** (4 Feb 1894–3 Nov 1968), daughter of **Leon H. Hicks** (25 Oct 1858–19 Sept 1929) and **Sarah Docia McGough** [Sallie] (Jan 1861–1921). Jesse and Annie are buried in the Taylor/Liberty Hill Cemetery, Farmerville, Union Parish, Louisiana.
- f. **Sarah Arnett Albritton** [Nettie] (21 Aug 1889–21 Jan 1949) married on 28 January 1911 to **Emmett L. Ward** (30 May 1890–16 Oct 1942), the son of **John Martin Ward** (22 Jan 1855–17 Nov 1905) and **Elizabeth Jane Meeks** [Bettie] (9 Oct 1856–1/2/9 July 1937). Nettie and Emmett are buried in the Taylor/Liberty Hill Cemetery, Farmerville, Union Parish, Louisiana.

- g. **Arnett Washington Albritton** (30 Jan 1892–13 May 1965) married on 21 December 1910 in Union Parish, Louisiana to **Jessie Anna McGough** (24 Jan 1894–30 Nov 1941), daughter of **Robert Armstrong McGough** (1 May 1854–3 Oct 1908) and **Sarah Ann Elizabeth Ward** (1 Apr 1858–2 Nov 1923). Arnett and Jessie are buried in the Taylor/Liberty Hill Cemetery, Farmerville, Union Parish, Louisiana.
 - h. **Enoch Joseph Albritton, Sr.** (31 Dec 1893–5 Nov 1967) married between April 12 and 17, 1913 in Union Parish, Louisiana to **Fay Hicks** (10 Jan 1897–11 Jan 1967), daughter of **Leon H. Hicks** (25 Oct 1858–19 Sept 1929) and **Sarah Docia McGough** [Sallie] (Jan 1861–1921). Enoch and Fay are buried in the Taylor/Liberty Hill Cemetery, Farmerville, Union Parish, Louisiana.
 - Their marriage record in Marriage Book 18, p. 76 shows it was filed by the court clerk on April 17. The security was given on April 12, but the minister failed to make a return to the court stating the precise date that he performed the marriage. It occurred between April 12 and April 17.
 - i. **Bessie Albritton** (20 Jan 1896–16 June 1981) married on 6 June 1914 in Union Parish, Louisiana to **Carl Miller** (19 Nov 1892–10 Mar 1977), son of **Peter Leonard Miller** (6 Aug 1871–15 Aug 1963) and **Sarah Brantley** [Sallie] (1 Sept 1874–8 Feb 1901). Bessie and Carl are buried in the Taylor/Liberty Hill Cemetery, Farmerville, Union Parish, Louisiana.
 - j. **Mertie Lovie Albritton** (25 Feb 1899–29 Mar 1973) married **Brady Elbert Hollis** (26 July 1899–13 Dec 1988), son of **Derrill Wolf Hollis** and **Nellie Alice Parker**. Lovie and Brady are buried in the Taylor/Liberty Hill Cemetery, Farmerville, Union Parish, Louisiana.
 - Brady's tombstone lists his birth as 26 July 1899, as does the Social Security index. However, when he registered for the draft for World War I, he signed that his date of birth was 25 July 1898. However, the 1900 census lists him as 11 months old in June 1900, with a birth month of July 1899.
 - k. **Woodie D. Albritton** (6 June 1902–28 Oct 1963) married about 3 January 1920 in Union Parish, Louisiana to **Bertha Scarborough** (3 Sept 1902–18 Dec 1984), daughter of **George Elliott Scarborough** (Dec 1878–30 Apr 1958) and **Minnie Mae Hill** (1880–24 Jan 1963). Woodie and Bertha are buried in the Taylor/Liberty Hill Cemetery, Farmerville, Union Parish, Louisiana.
 - Their marriage was recorded in Marriage Book 19, p. 581. The court issued the license on January 3, but the minister failed to make a return stating exactly when he performed the ceremony. It was either on January 3 or a few days later.
 - l. **Gladys Evelyn Albritton** (7 Jan 1906–12 Mar 1988) married on 26 July 1925 in Union Parish, Louisiana to **Wilber D. Taylor** [Joe] (28 July 1906–15 Aug 1988), son of **Joseph Baker Taylor** (28 Dec 1873–2 May 1965) and **Nettie Alma Miller** (10 July 1878–28 July 1973). Gladys and Wilbur are buried in the Taylor/Liberty Hill Cemetery, Farmerville, Union Parish, Louisiana.
 - m. **James B. Albritton** (17 Oct 1907–25 Nov 1989) married on 1 February 1929 in Union Parish, Louisiana to **Eunice Murphy** (10 July 1912–30 Jan 2003), daughter of **Mallie D. Murphy** (22 Jan 1890–20 Feb 1940) and **Bernice Taylor** (4 July 1895–12 Mar 1964). James and Eunice are buried in the Taylor/Liberty Hill Cemetery, Farmerville, Union Parish, Louisiana.
 - n. **John Lee Albritton** (7 Nov 1909–2 July 1979) married **Audrey Armstrong** (23 Sept 1912–23 Apr 2001). John and Audrey are buried in the Farmerville Cemetery, Farmerville, Union Parish, Louisiana.
5. **John Fowler Albritton** (12 Nov 1860–14 Aug 1925) married on 7 September 1882 in Union Parish, Louisiana to **Frances James Boatright** (8 Apr 1863–14 Feb 1930), daughter of **James Boatright** (1821/1822–29 Nov 1862) and **Jane Elizabeth Stiles** (c1824–July/Aug 1896). John and Frances Albritton are buried in the Taylor/Liberty Hill Cemetery.
- John F. Albritton's tombstone gives his date of death as August 13. However, his death certificate clearly states that his death occurred on August 14, with his burial following on August 15. The death certificate states that his age at death was 64 years, 9 months, and 2 days. Since death certificates were completed immediately after the death and tombstones sometimes took a year or more to erect, it would appear likely that the tombstone date is incorrect.

Known children of John and Fannie Albritton:

- a. **Lloyd Wilson Albritton** (30 May 1883–12 Aug 1967) married on 28 December 1904 to **Katherine Isabel Green** [Belle] (13 July 1883–20 Apr 1967), daughter of **Abner A. Green** (28 Jan 1854–26 Jan 1925) and **Martha Elizabeth Murry** [Bettie] (28 Dec 1858–15 Feb 1931). Lloyd and Bell Albritton are buried in the Taylor/Liberty Hill Cemetery, Farmerville, Union Parish, Louisiana.
- b. **John Washington Albritton** (16 Jan 1885–3 Aug 1923) married on 24 July 1904 to **Mattie Cole** (28 May 1888–20 Feb 1946), daughter of **Mary Swafford Cole** (4 June 1856–10 Apr 1932). John and Mattie Albritton are buried in the Taylor/Liberty Hill Cemetery, Farmerville, Union Parish, Louisiana.
 - John's tombstone has his year of birth as 1884.

- The 1900 Federal Census and John's World War I Draft Registration give his birth in January 1885. As a birth in January 1884 would put him only eight months younger than his older brother, it would seem that he was indeed born in 1885.
 - c. **Robert Gemes Albritton** (12 Oct 1887–1 Sept 1945) married on 28 November 1909 in Union Parish, Louisiana to **Minnie Lee Honeycutt** (12 Apr 1888–2 May 1972). Robert and Minnie Albritton are buried in the Farmerville Cemetery, Farmerville, Union Parish, Louisiana.
 - d. **Rufus Henry Albritton** (24 Oct 1889–25 Oct 1952) married on 2 December 1911 in Union Parish, Louisiana to **Ora Gustava Brazzeal** (12 Apr 1894–4 Dec 1993), daughter of **Noel Gorden Brazzeal** (27 Aug 1873–16 July 1949) and **Martha Harriett Patterson** (20 Feb 1875–26 May 1961). Rufus and Ora Albritton are buried in the Taylor/Liberty Hill Cemetery, Farmerville, Union Parish, Louisiana.
 - e. **Joseph Ollie Albritton** [Joe] (8 Jan 1892–17 May 1964) married on 8 July 1920 in Union Parish, Louisiana to **Mary Elise Slawson** (21 Aug 1894–13 May 1973), daughter of **Daniel S. Slawson** (24 Jan 1859–21 May 1936) and **Annie Schneider** (1 June 1871–9 Apr 1923). Joe and Elsie Albritton are buried in the Farmerville Cemetery, Farmerville, Union Parish, Louisiana.
 - f. **Emmett Noah Albritton** (24 Nov 1893–22 Apr 1956) married on 5 May 1923 in Union Parish, Louisiana to **Hazel M. Norris** (26 Feb 1901–21 Feb 1977). Emmett and Hazel Albritton are buried in the Farmerville Cemetery, Farmerville, Union Parish, Louisiana.
 - Emmett and Hazel's daughter, **Emmlyn Norris Albritton** (6 Feb 1935–30 Jan 2000), is buried with them in a triple plot.
 - g. **George Grady Albritton** (3 Feb 1896–17 Jan 1952) married on 2 September 1933 in Union Parish, Louisiana to **Addie Mae Ulmer** (c1908–after 1940), daughter of a Mr. **Ulmer** and **Gettie E. ?** (1870–23 Nov 1947). Grady is buried in the Farmerville Cemetery, Farmerville, Union Parish, Louisiana.
 - Grady G. Albritton earned a B.S. in 1921 and M.S. in 1926, both from Louisiana State University. He earned a Ph.D. from University of North Carolina-Chapel Hill in 1930. He was one of the original faculty members of Northeast Louisiana Junior College in Monroe (later Northeast Louisiana University and today, University of Louisiana-Monroe). He also served as a faculty member at Texas A&M College and the University of Tennessee.
 - In 1940, Grady lived in Hammond with his wife on North Magnolia Street and taught chemistry at Southeastern Louisiana College. The *Monroe News-Star* issue of 25 January 1952, p. 16, stated that Dr. Grady G. Albritton then served as Dean of the Division of Liberal Arts and Department Head of Physical Sciences, Southeastern Louisiana College. He joined the faculty of Southeastern Louisiana College in 1939. He was a member of the American Chemical Society and the Louisiana Academy of Sciences.
 - "The *Monroe News-Star*" (Monroe, LA), 17 January 1952 carried the notice of Dr. Grady G. Albritton's death in a Hammond Hospital at 8:15 a.m., following a heart attack. Survivors included his wife, sister, and several brothers. Nothing further is known about his wife.
 - h. **Sarah Myrtle Albritton** [Sallie] (11 Oct 1898–17 Nov 1982) married on 20 October 1919 in Union Parish, Louisiana to **Lawrence Emmette McGough** (12 Mar 1892–20 Nov 1969), son of **Robert Armstrong McGough** (1 May 1854–3 Oct 1908) and **Sarah Ann Elizabeth Ward** (1 Apr 1858–2 Nov 1923). Sallie and Lawrence McGough are buried in the Taylor/Liberty Hill Cemetery, Farmerville, Union Parish, Louisiana.
 - i. **Raymond Albritton** [Red] (18 Mar 1903–22 May 1978) married on 2 June 1928 in Union Parish, Louisiana to **Willie Lee Sawyer** (19 Feb 1905–10 Apr 1979), daughter of **Alvin Bain Sawyer** (1 May 1878–15 Feb 1962) and **Vada Honeycutt** (7 Aug 1882–6 Aug 1945). Raymond and Willie Albritton are buried in the Farmerville Cemetery, Farmerville, Union Parish, Louisiana.
 - j. **Irvin Gray Albritton** (31 Aug 1908–14 Apr 1996) married on 7 January 1928 in Union Parish, Louisiana to **Anna Mae Taylor** (13 Mar 1910–5 May 1999). Irvin and Anna Mae Albritton are buried in the Greenwood Cemetery, Ruston, Lincoln Parish, Louisiana.
6. **Matthew Leonard Albritton** (23 Mar 1862–29 Oct 1944) married on 14 January 1892 in Union Parish, Louisiana to **Ella Jordan** (10 Sept 1864–11 Oct 1952). Matthew and Ella are buried in the Taylor/Liberty Hill Cemetery, Farmerville, Union Parish, Louisiana.
- Ella's son, Clarence, provided the information on her death certificate, and he did not know the names of his grandparents. He stated that she was a native of Lee County, Alabama and had lived in the Farmerville region for sixty years.

Known children of Matthew and Ella Albritton, all of whom are buried in the Taylor/Liberty Hill Cemetery, Farmerville, Union Parish, Louisiana:

- a. **Earl Linuel Albritton** (2 Jan 1893–4 Oct 1978) married on 12 September 1920 in Union Parish, Louisiana to **Ossie Velma Odom** (9 Mar 1901–Apr 1985), daughter of **James Duncan Odom** (12 Oct 1860–15 Mar 1925) and **Zilpha Elizabeth Ann Agerton** (17 Mar 1860–22 Feb 1925).
 - b. **Matthew Clyde Albritton** (14 Mar 1895–22 Apr 1990) married on 20 November 1920 in Union Parish, Louisiana to **Willie Mae Jones** (1 May 1903–24 Feb 1989), daughter of **Lott Jones** (1881–1957) and **Josie Webb** (1884–1968).
 - c. **Clarence Albritton** (23 Mar 1898–Oct 1969) married **Frances McVicker** [Fannie] (5 Dec 1903–15 Sept 1988).
 - d. **Homer Clayton Albritton** (4 Sept 1902–Jan 1988) married about 1928 to **Della Faye** (16 May 1911–Jan 1987). Homer married on 11 October 1935 in Union Parish, Louisiana to **Lois Lola Ward** (5 June 1910–Aug 1978), daughter of **George Allen Ward** (13 May 1874–11 May 1938) and **Mary Elizabeth Smith** (2 Mar 1878–20 July 1949).
 - Lois first married on 1 March 1928 in Union Parish, Louisiana to **Benjamin Murphy**, the son of **Frederick** and **Margaret Murphy**. Ben died prior to her marriage to Homer.
7. **Jesse Rountree Albritton** (23 Mar 1862–13 Feb 1936) married on 9 January 1883 in Union Parish, Louisiana to **Frances Camelle Etheridge** [Mellie] (19 Sept 1868–24 Mar 1945), daughter of **John Green Etheridge** (7 May 1822–6 Oct 1890) and **Nancy Castleberry** (4 July 1830–4 July 1908). Jesse and Mellie Albritton are buried in the Magnet Cove Cemetery, Hot Spring County, Arkansas.

Known children of Jesse and Frances Albritton:

- a. **Vada Albritton** (6 Feb 1884–5 May 1885).
 - b. **Ader Albritton** (6 Feb 1884–14 Sept 1894).
 - c. **Mary Albritton** (27 July 1885–4 Aug 1886) is buried in the Old Magnet Cove Cemetery, Hot Spring County, Arkansas.
 - d. **Robert Larkin Albritton** (12 Aug 1887–27 Apr 1962) married on 6 January 1924 in Garland County, Arkansas to **Virginia A. Terry** [Virgie] (31 July 1897–26 Aug 1955), daughter of **Orton Hammer Terry** (1868–1947) and **Edna Cora Oliver** (7 Aug 1869–19 Jan 1930). Robert and Virgie are buried in the Memorial Gardens Cemetery in Hot Springs, Garland County, Arkansas.
 - e. **Joseph Z. Albritton** [Joe] (23 Nov 1888–10 Nov 1960) married on 1 June 1910 in Garland County, Arkansas to **Mattie L. Buchanan** (7 Dec 1884–3 June 1959). Joe and Mattie are buried in the Greenwood Cemetery in Hot Springs, Garland County, Arkansas.
 - f. **George Albritton** (23 Aug 1890–10 Aug 1894) is buried in the Old Magnet Cove Cemetery, Hot Spring County, Arkansas.
 - g. **Lester Albritton** (30 July 1893–11 Sept 1894) is buried in the Old Magnet Cove Cemetery, Hot Spring County, Arkansas.
 - h. **William Arnett Albritton** (26 Oct 1895–8 Oct 1966) married on 16 April 1935 to **Nealie Eula Williams**. William is buried in the Magnet Cove Cemetery in Magnet Cove, Hot Spring County, Arkansas.
 - i. **Homer Jewell Albritton** (26 Sept 1897–9 Sept 1943) married on 1 January 1924 to **Bessie Brown**. He married on 10 August 1929 in Union County, Arkansas to **Gertrude Evans** (3 Feb 1907–27 Mar 1973). Homer and Gertrude are buried in the Magnet Cove Cemetery, Magnet Cove, Hot Spring County, Arkansas.
 - j. **Odus Elliott Albritton** (26 May 1902–23 July 1993) married on 15 April 1922 to **Vera Allie Johnson** (6 Jan 1905–2 Apr 1924), daughter of **George Albert Johnson** (28 June 1881–15 Feb 1942) and **Mary Haynie** (18 Dec 1887–19 Apr 1991). Odus married on 1 February 1927 to **Lydia Lillian Wright** (17 Sept 1905–9 Sept 1973), daughter of **William M. Wright** (1880–1932) and **Sarah Octavia ?** (19 Sept 1883–15 Jan 1978). Odus and Lydia are buried in the Magnet Cove Cemetery, Magnet Cove, Hot Spring County, Arkansas.
 - Odus Albritton served as the fire chief of Malvern, the county seat.
8. **Joseph Ford Albritton** (20 Apr 1864–9 Aug 1934) married on 8 March 1891 in Union Parish, Louisiana to **Holland Slawson** (20 Nov 1871–17 Aug 1942), the daughter of **Albert Slawson** (c1825–29 June 1895) and **Mary E. Thurston** (Nov 1844–after 1900). Joe and Holland are buried in the Taylor/Liberty Hill Cemetery, Farmerville, Union Parish, Louisiana.

Known children of Joe and Holland Albritton:

- a. **Theodosia Mae Albritton** [Docie] (1893 –1960) married Mr. **Sanderlin**. Docie Mae is buried in the Taylor/Liberty Hill Cemetery.
- b. **Elva Elizabeth Albritton** [Elvie] (7 Nov 1894–4 Aug 1937) married on 17 August 1915 in Union Parish, Louisiana to **Henry Lee Phillips** (24 Oct 1894–24 Feb 1947), son of **Soldier D. Phillips** (1862–1946) and **Cynthia Elizabeth Malone** (1867–1931). Elvie and Henry are buried in the Taylor/Liberty Hill Cemetery.

- c. **Jessie A. Albritton** (1895–1920) married on 13 November 1910 in Union Parish, Louisiana to **Sheppard Kennedy** [Shep] (30 Jan 1888–1 Nov 1954), son of **John Wilson Kennedy** (3 May 1849–23 Sept 1913) and **Elizabeth Victoria McGough** (3 Oct 1856–19 July 1921). Jessie and Shep are buried in the Taylor/Liberty Hill Cemetery.
 - d. **Frances P. Albritton** [Fannie] (Mar 1898–after 1910) reportedly married **Paul Nettles**.
 - e. **Mary Albritton** (1900–22 Oct 1928) married on 10 August 1921 in Union Parish, Louisiana to **Sheppard Kennedy** [Shep] (30 Jan 1888–1 Nov 1954), son of **John Wilson Kennedy** (3 May 1849–23 Sept 1913) and **Elizabeth Victoria McGough** (3 Oct 1856–19 July 1921). Mary and Shep are buried in the Taylor/Liberty Hill Cemetery.
 - f. **Cora Albritton** (6 Nov 1902–26 Jan 1956) married on 5 January 1921 in Union Parish, Louisiana to **Robert B. Kennedy** [Bert] (2 Jan 1886–15 Aug 1972), son of **John Wilson Kennedy** (3 May 1849–23 Sept 1913) and **Elizabeth Victoria McGough** (3 Oct 1856–19 July 1921). Cora and Bert are buried in the Taylor/Liberty Hill Cemetery.
 - g. **Sarah Albritton** (14 Oct 1904–30 July 1958) married on 1 January 1927 in Union Parish, Louisiana to **Henry Wesley Rogers** (31 Oct 1883–16 May 1945), son of **James Daniel Rogers** (12 Oct 1851–27 Nov 1922) and **Julia Annis Auld** (2 Dec 1850–5 Feb 1902). Sarah and Henry are buried in the Shady Grove Cemetery near Farmerville, Union Parish, Louisiana.
 - h. **Joseph Ford Albritton, Jr.** [Buck] (14 Aug 1906–13 Aug 1962) is buried in the Taylor/Liberty Hill Cemetery.
 - Family information relates that Buck Albritton “*was afflicted*,” and he lived longer than any of the other children. He died in Ouachita Parish.
 - i. **Irene Albritton** (3 Nov 1911–9 Feb 1916) is buried in the Taylor/Liberty Hill Cemetery.
9. **Sarah Ann Elizabeth Albritton** [Lizzie] (20 Jan 1866–22 Apr 1903) married on 26 November 1884 in Union Parish, Louisiana to **Elza Alonza Edwards** (1 Apr 1863–15 Aug 1886). Sarah married on 20 April 1893 in Union Parish, Louisiana to **John Marshall Cooper** (14 Feb 1862–25 May 1915), son of **Columbus Marshall Cooper** (30 Mar 1835–21 Sept 1903) and **Mary Elizabeth Robinson** [Lizzie] (1842–1918). Sarah Albritton Edwards Cooper and Elza Edwards are buried in the Edwards Family Cemetery, Union Parish, Louisiana. John M. Cooper is buried in the Strong Cemetery, Strong, Union County, Arkansas.

Known child of Lizzie Albritton and Elza A. Edwards:

- a. **Sarah A. Edwards** [Sallie] (25 June 1886–26 Sept 1898) is buried in the Edwards Family Cemetery, Union Parish, Louisiana.

Known children of Lizzie Albritton and John M. Cooper:

- b. **John Edwin Cooper** (2 Mar 1894–27 Oct 1971) married **Golda Nelson** (28 Nov 1892–16 May 1975), daughter of **Columbus Simpson Nelson** (30 July 1852–21 June 1926) and **Nancy Bolding** [Nanny] (4 Apr 1863–20 Oct 1938). John and Golda Cooper are buried in the Strong Cemetery, Strong, Union County, Arkansas.
- c. **Vera Cooper** (9 Sept 1895–14 May 1929) married **Alvin P. Kirby** (13 Sept 1862–31 July 1947), son of **William Henry Kirby** (12 May 1805–28 Aug 1888) and **Julia Ann Wood** (5 May 1821–12 Oct 1869). Vera and Alvin Kirby are buried in the Strong Cemetery, Strong, Union County, Arkansas.
- d. **Robert Lee Cooper** [Lee] (2 Aug 1897–17 Oct 1975) married **Bernice ?**. Robert is buried in the Robstown Memorial Park Cemetery, Robstown, Nueces County, Texas, Plot J-08-004.
- e. **William Paul Cooper** [Willie] (18 Nov 1898–20 Oct 1966) married **Lyda Sue ?** (10 Oct 1897–14 Dec 1983). Willie Paul and Lyda Sue Cooper are buried in the Robstown Memorial Park Cemetery, Robstown, Nueces County, Texas, Plot J-09-014A.
- f. **Velma Elizabeth Cooper** (28 Feb 1901–27 July 1985) married **Frank H. Burnside** (20 Dec 1898–4 Aug 1954). Velma and Frank Burnside are buried in the Arlington Memorial Park Cemetery, El Dorado, Union County, Arkansas.
- g. **Clyde C. Cooper** (22 Apr 1903–28 Apr 1976) reportedly married **Marcie Dunn**. Clyde is buried in the Strong Cemetery, Strong, Union County, Arkansas.
- h. **Claud Cooper** (21 Apr 1903–6 Feb 1904) is buried in the Edwards Family Cemetery, Union Parish, Louisiana.

♦ ♦ ♦ ♦ ♦

7. R. Walter Fowler

R. Walter Fowler (26 June 1825–after 1847) married on 12 May 1847 in Clarke County, Alabama to **Laura A. Talbert**. It appears and he and his wife lived in the household of Richard and Sarah Fowler in Wilcox County, Alabama when enumerated on the 1850 Alabama State Census. There is no further known record of him or any possible descendants.

♦ ♦ ♦ ♦ ♦ ♦

8. Susannah Fowler

Susannah Fowler [Susan] (3 Dec 1827–28 Sept 1909) married about 1851, probably in Wilcox County, Alabama, to **James Rountree Albritton** (27 Dec 1826–21 June 1911), the son of **Allen Albritton** (17 Nov 1794–8 Dec 1861) and **Susanna Ford** (17 June 1803–12 Oct 1867). Susan and James are buried in the Prairie Point Cemetery in Navarro County, Texas. Known children of Susan Fowler and James R. Albritton:

1. **Mary Jane Albritton** [Mollie] (c1852–1870/1875) married on 14 April 1869 in Wilcox County, Alabama to **William Madison Purifoy, Jr.** (27 Oct 1848–1915).
2. **John Wilson Albritton** (26 Nov 1852–29 Nov 1939) married on 29 September 1871 in Dallas County, Alabama to **Emma Emaline Warr** (23 Apr 1852–10 Apr 1937), daughter of **Evans Wilson Warr** (10 Mar 1814–9 Dec 1874) and **Elizabeth Edwards** (1824–31 Oct 1896). John W. and Emma Albritton are buried in the Bazette Cemetery in Bazette, Navarro County, Texas.
 - Elder J. Capers James signed this return in the Dallas County courthouse regarding their marriage: *"The above named parties were married by me at The Bride's Father."*
 - Along with relatives, they moved to Texas between 1875 and 1880, when they lived near John's uncle, Allen K. Albritton, in Navarro County.
 - The 1900 and 1910 Federal Censuses indicate that Emma had given birth to two children, both deceased. Thus, their only children must have been the two infant sons listed below.
 - In 1900, John and Emma had an adopted daughter and son living in their household: Rosa Jordan (born January 1883) and Noah Jordan (born March 1888).

Sons of John W. and Emma E. Albritton, both buried in the Snow Hill Cemetery, Wilcox County, Alabama:

- a. **James E. Albritton** (1873–1873).
- b. **John Wilson Albritton, Jr.** (1874–1874).
3. **Martha Catherine Albritton** (16 Feb 1857–4 Mar 1951) married on 2 or 4 October 1883 in Freestone County, Texas to **John Thornton Clark Jr.** (11 July 1850–25 Jan 1915), son of **John Thornton Clark** (c1815–1850/1855) and **Sarah Ann Stillwell** (11 Dec 1823–29 Jan 1893). Martha and John are buried in the Antelope Cemetery, Antelope, Jack County, Texas.
 - John T. Clark's mother married second to Roderick Oliver (15 Feb 1800–2 Oct 1857), and their son, **Roderick Henry Oliver** (1858–11 Mar 1917), had married Martha's younger sister in 1881.
 - In 1900, Martha and John lived in Clay County, Texas with her parents. In 1910, they lived in Jack County, Texas. After John's death in 1915, Martha lived with her younger son, William in Jack County. In 1930, she lived with her cousin, Ira A. Albritton, in Wichita Falls, Texas.
 - Martha died near the town of Shannon, in Clay County, Texas, at the age of ninety-four years. Mrs. H. O. Whitsell provided the information on the certificate. John's mother is buried near him in the Antelope Cemetery, Jack County, Texas.

Known children of Martha and John Clark:

- a. **Shellie Thornton Clark** (22 Sept 1884–22 Feb 1920) married on 25 December 1904 in Clay County, Texas to **Portia May Fry** (14 Feb 1886–28 May 1951), daughter of **Jessie F. Fry** (28 Dec 1839–10 Oct 1924) and **Jemima McCormick** (18 July 1846–13 Sept 1920). Shellie and Portia Clark are buried in the Antelope Cemetery, Antelope, Jack County, Texas.
 - After Clark's death, Portia married in 1925 to Ernest Maxwell (7 Feb 1895–29 Oct 1976).
 - Shellie and Portia had son, James Terrell Clark (29 Nov 1905–6 Nov 1970), daughter Elzina Clark (born 1907), daughter Nina Fay (born 23 October 1914), and son Howard born in 1917.
- b. **William Briscoe Clark** (3 Feb 1888–17 July 1974) married in the early 1910s to **Willa Edna Westmoreland** (20 Nov 1893–3 July 1948). William and Willa are buried in the Antelope Cemetery, Antelope, Jack County, Texas.
4. **William Henry E. Albritton** [Henry] (1 Apr 1859–23 Feb 1942) married on 18 November 1883 in Freestone County, Texas to **Patience Eugenia Green** [Gina] (10 July 1868–29 Jan 1931). William is buried in the Kerens Cemetery near Kerens, Navarro County, Texas.
 - Numerous records give his name as *"William Henry Albritton."* However, the 1860 Federal Census records him as *"W. H. E Albritton."*

Known children of William and Patience Albritton:

- a. **Samuel Edgar Albritton, Sr.** (1 Oct 1884–21 Nov 1965) married on 5 August 1907 in Navarro County, Texas to **Ethel Ella Albritton** (2 May 1890–29 Aug 1972), daughter of **Daniel Webster Albritton** and **Elizabeth Ray**. Samuel and Ethel are buried in the Mont Meta Memorial Park Cemetery, San Benito, Cameron County, Texas.
 - Edgar and Ethel farmed in Navarro County in 1910. She had no children at that time.
 - In 1920, they farmed in Cameron County, Texas with their daughters/ In 1930 and 1940, Edgar and Ethel still lived in Cameron County with their daughters and son.
 - Samuel E. Albritton died in Harlingen, in the Valley Baptist Hospital of pneumonia. Ethel died of uterine cancer.

Children of Samuel E. and Ethel E. Albritton:

 - i. **Clellia Rozelle Albritton** (22 Sept 1912–17 Mar 2003) married on 15 August 1940 to Charlie Jern Cherry (5 Dec 1910–18 Dec 1985), son of Charles William Cherry (27 Oct 1887–11 Dec 1952) and Cora Lee Oliver (20 Mar 1880–7 Apr 1978). Clellia and Charlie Cherry are buried in the Parker Cemetery, Grapeland, Houston County, Texas.
 - ii. **Cladda Mae Albritton** (c1918–after 1940).
 - iii. **Samuel Edgar Albritton Jr.** (20 Dec 1925–27 Dec 2005) married on 6 May 1946 to Rosa Nell Parker (23 Aug 1926–24 Apr 2020), daughter of Joseph Henry Parker (1884–1958) and Julia Pearl Dodson (1897–1989). Samuel served in the United States Army during World War II. Samuel and Rosa Albritton are buried in the College Station Cemetery, Brazos County, Texas, Section H/012/005.
 - b. **Verda Albritton** (Dec 1887–after 1931) married on 10 July 1904 in Navarro County, Texas to **Uriah A. McAlister** (c1880–after 1910).
 - In 1910, Verda and Uriah lived in Corsicana with their two young children. He worked as a grocery merchant. In 1931, she lived in Dallas, Texas.
 - c. **Maudie Lerah Albritton** (2 Sept 1889–9 Feb 1977) married on 23 October 1910 in Navarro County, Texas to **Alfred Baker Guinn** (10 May 1886–21 Dec 1969), son of **Alfred Henry Guinn** (6 May 1858–16 Sept 1945) and **Martha Bell Farley** [Mattie] (3 Dec 1857–23 May 1918). Maudie and Alfred Guinn are buried in the Lamesa Memorial Park Cemetery, Lamesa, Dawson County, Texas.
 - d. **Mary E. Albritton** (Jan 1892–1900/1931).
 - e. **Anna B. Albritton** [Annie] (3 Sept 1894–26 June 1975) married on 17 December 1916 in Navarro County, Texas to **George Elvie Finley** (24 Nov 1895–7 Sept 1941). Annie Albritton Finley Lewis is buried in the Rose Lawn Memorial Gardens, Brownsville, Cameron County, Texas. George Elvie Finley is buried in the Bazette Cemetery, Bazette, Navarro County, Texas.
 - Annie and Elvie farmed in Navarro County in 1920 with their two young children, Winnie B. and Willie B. Finley.
 - In 1920, they lived in San Benito, Cameron County, Texas, where he worked as a superintendent and she as a laundress out of their home. In later years, she worked as a nurse.
 - f. **John Allen Albritton** (3 Aug 1898–26 Dec 1960) married **Ola L. Herring** (20 Jan 1902 – 14 Sept 1937), daughter of **W. W. Herring** and **Anna C. Hardy**. John A. and Ola Albritton are buried in the Laurel Land Memorial Park, Dallas, Dallas County, Texas.
 - Allen lived with his parents in Navarro County, Texas in 1900, 1910, and 1920. He served in the U.S. Army during World War I and later worked for the U.S. Department of Agriculture. He moved to Memphis, Tennessee during the 1950s to live near his daughter.
 - g. **E. T. Albritton** (26 Sept 1901–19 Oct 1986) married on 3 December 1923 in Navarro County, Texas to **Mattie Mae McQuary** (7 June 1907–14 July 2001). E. T. and Mattie are buried in the Bazette Cemetery, Navarro County, Texas.
 - h. **Lois Albritton** (1 Mar 1907–15 June 1986) married on 26 April 1929 in Navarro County, Texas to **Christopher Tyner** (27 Apr 1902–6 Oct 1986). Lois and Chris are buried in the Prairie Point Cemetery near Bazette, Navarro County, Texas.
 - i. **William Ernest Albritton** (7 June 1910–10 Sept 1981) married on 14 December 1928 in Navarro County, Texas to **Angie Muriel Hardaway** (19 Apr 1910–12 Apr 1998), daughter of **Archie Tanner Hardaway** (12 May 1890–5 Aug 1975) and **Jessie Mae Smith** (5 Aug 1888–24 Feb 1976). Ernest and Muriel Albritton are buried in the Prairie Point Cemetery near Bazette, Navarro County, Texas.
5. **Susan Elvira Albritton** [Ella] (8 Oct 1863–26 Sept 1948) married on 18 or 20 December 1881 in Freestone County, Texas to **Roderick Henry Oliver** [Rod] (1858–11 Mar 1917), son of **Roderick Oliver** (15 Feb 1800–2 Oct 1857) and **Sarah Ann Stillwell** (11 Dec 1823–29 Jan 1893). Ella and Roderick Oliver are buried in the Antelope Cemetery, Antelope, Jack County, Texas.

- Roderick H. Oliver was born in 1858 in Freestone County, Texas, after the death of his father a few months earlier. His father is buried in the Fairfield Cemetery, Freestone County, Texas. In 1860, Roderick H. Oliver lived in Freestone County, Texas with his mother, his stepfather, Leonard Mitchel Riley, and his half-brother, John Thornton Clark Jr., who married his wife's sister, Susan Elvira Albritton, in 1883. Roderick's mother is buried near him in the Antelope Cemetery, Jack County, Texas.
- Roderick's middle name, precise date of death, and location of death come from an undocumented source. His tombstone merely has his year of death as 1917. He apparently has no death certificate.
- In 1900, Ella and Rod Oliver and their siblings, Mattie Albritton and John Clark, lived on adjoining farms in Clay County, Texas. Their parents had recently left their farm in Navarro County and lived with them. In 1910, Ella and Rod worked their Clay County, Texas farm, together with their many children.
- In 1920, Ella lived with her single children in Jack County, Texas, but in 1930 and 1940, she lived with them in Clay County, Texas.
- Ella Albritton Oliver died in the Bethania Hospital in Wichita Falls, Wichita County, Texas, nineteen days after suffering a stroke caused by high blood pressure.

Known children of Susan Elvira and Roderick H. Oliver:

- a. **Roderick Thornton Oliver** [Rodie, Rod] (14 Oct 1882–2 Apr 1936) remained single. Rod Oliver is buried in the Antelope Cemetery, Antelope, Jack County, Texas.
 - He worked as a stock farmer and died of endocarditis, a bacterial infection of the heart.
- b. **Beulah Elizabeth Oliver** (11 Sept 1884–5 Jan 1962) married about 1906 to **John Terrell Fry** (27 Feb 1884–13 Feb 1960), son of **Jessie F. Fry** (28 Dec 1839–10 Oct 1924) and **Jemima McCormick** (18 July 1846–13 Sept 1920). Beulah and John are buried in the Antelope Cemetery, Antelope, Jack County, Texas.
- c. **Lella Lee Oliver** (6 Apr 1886–7 Jan 1978) married on 6 April 1903 in Clay County, Texas to **William B. Skelton** (12 Mar 1883–22 May 1956), son of **J. N. Skelton** and **Helena Wofford**. Lella and William Skelton are buried in the Crestview Memorial Park Cemetery in Wichita Falls, Wichita County, Texas.
- d. **Mable Maude Oliver** (4 Apr 1888–24 Sept 1943) married on 3 June 1920 in Clay County, Texas to **William James McCall** (1885–1944). Maude and William McCall are buried in the Antelope Cemetery, Antelope, Jack County, Texas.
 - Maude and William lived in Wichita Falls, Texas in 1930.
 - Maude died of uterine cancer.
- e. **Velma M. Oliver** (17 Jan 1890–5 Sept 1962) is buried in the Antelope Cemetery, Antelope, Jack County, Texas.
- f. **Wallace William Oliver** (14 Feb 1892–29 Oct 1965) married on 5 December 1926 in Clay County, Texas to **Emma Jemima Fry** (21 Apr 1888–17 Sept 1964), daughter of **Jessie F. Fry** (28 Dec 1839–10 Oct 1924) and **Jemima McCormick** (18 July 1846–13 Sept 1920). Wallace and Emma Oliver are buried in the Antelope Cemetery, Antelope, Jack County, Texas.
- g. **Sarah Ann Oliver** (13 Mar 1896–15 May 1974) married **Henry Shipp Moore** (9 Nov 1891/1892–15 May 1974), son of **William Davidson Moore** and **Minnie Selby**. Sarah and Henry Moore are buried in the Antelope Cemetery, Antelope, Jack County, Texas.
 - Sarah and Henry burned to death in a fire that engulfed the building before firefighters arrived. See *"Fort Worth Star-Telegram"* (Fort Worth, TX), 15 May 1974, p. 2, column 3.
 - Henry's tombstone has his year of birth as 1891. His death certificate has 9 November 1892.
- h. **Linda Oliver** (Dec 1897–after 1920) lived with her parents and siblings in 1900, 1910, and 1920.
- i. **Edith Ellen Oliver** (24 June 1900–18 Feb 1979) married on 19 August 1919 in Jacksboro, Texas to **Maurice Clerihew** (26 June 1898–2 Jan 1988), son of **Arthur Richardson Clerihew** (10 May 1868–25 Jan 1948) and **Laura E. Curtsinger** (14 June 1871–18 Jan 1943). Edith and Maurice Clerihew are buried in the Antelope Cemetery, Antelope, Jack County, Texas.
- j. **Frank Elbert Oliver** (11 Aug 1902–9 Dec 1971) married on 15 August 1926 in Archer, Texas to **Mildred Irene Ward** (14 June 1911–30 Sept 1999). Frank and Mildred Oliver are buried in the Antelope Cemetery, Antelope, Jack County, Texas.
- k. **Stayton Allen Oliver** (1 Oct 1908–22 Jan 1963) married on 17 March 1928 in Parker County, Texas to **Mary Ruth Garrett** (22 Feb 1913–29 Jan 2000), daughter of Barnum Eugene Garrett (16 Apr 1851–26 Feb 1920) and Cordelia Wall [Delia] (27 Aug 1873–4 Oct 1945). Stayton and Mary Oliver are buried in the Antelope Cemetery, Antelope, Jack County, Texas.
 - Stayton died of a heart attack at the local high school gym.



Notes

1. Richard and Sarah Fowler's exact dates of birth comes from their Family Bible, transcribed herein. John Fowler Revolutionary War Pension Application, #S16809, North Carolina. Duplin County NC Estate Records, 1813, Joshua Rackley. Fowler, Richard Gildart. *A History of the Fowler Family of Southeastern North Carolina*. Privately printed, 1985, pp. 15–18, 25A, 28–29. This work describes the migrations of John Fowler and his wife, Elizabeth Rackley, including the years they spent in South Carolina.
2. Compiled Military Service Records, War of 1812, Major Lillington's Detachment, North Carolina Militia, Richard Fowler, Microfilm Publication M602, National Archives and Records Service.
3. Some have speculated that Richard Fowler was married to two different women with the given name of "Sarah," given a four-year gap in the births of his daughters (between 1819 and 1823). However, gaps often occur due to miscarriages, etc., and there is no other evidence that he had more than one wife. One confusing point about the family tradition of Sarah's maiden name of "*Paramore*" or "*Parramore*" is that we cannot locate any nearby families with this surname during this time period.
4. Richard Fowler witnessed a land transaction in Columbus County on 1 November 1815 with his brother-in-law, Isaac Simmons (Columbus County NC Deed Book B, pp. 96–97). On 26 October 1817, Fowler and another brother-in-law, William Sims, witnessed the transaction in which John Fowler purchased two tracts of land (Columbus County NC Deed Book B, pp. 308–309). Richard Fowler's farm location and his neighbors come from records made a decade after he had left North Carolina for Alabama (Columbus County NC Deed Books E, pp. 28–30 [10 May 1828], and H, pp. 214–215 [4 Mar 1829]). These documents show Richard Fowler's land lying next to that of John Fowler, John Wilson, and the Sikes. There are no recorded deeds in Columbus County that show Richard Fowler buying or selling land. He could have rented the land, or his land transactions may have gone unrecorded. The Fowler Bible records Milly Fowler's date of birth as 23 December 1817. Milly died before 1850, and so no census shows her place of birth. The 1880 census listing of her second son, James Andrew Albritton, shows his mother born in North Carolina (1880 Sevier County AL Federal Census, Population Schedule, Clear Creek Township, Household #161, ED 269, p. 18). On the other hand, the 1880, 1900, and 1910 census listings of Milly's eldest son, Enoch Richard Albritton, all show his mother's birthplace as Georgia, the same as his father. There are no other records that show Richard Fowler as a Georgia resident, so presumably Enoch or whoever reported this information confused his mother's place of birth with that of his father (who was indeed born in Georgia). Thus, it appears that Richard and Sarah remained in Columbus County until after Milly's birth in December 1817.
5. The Fowler Bible records the birth of "*Mantha Fowler*" on this date. Later records verify that "*Manthy Fowler*" was actually Samantha Fowler who married Noah Scarborough in 1837 (Wilcox County AL Marriage Book 1826–1840, pp. 302, 352, Noah Scarborough to Samantha Fowler; Wilcox County AL Deed Book E, p. 369, Noah and "*Manthy*" Scarborough sell 80 acres of land near Snow Hill). The 1850–1900 Union Parish LA Federal Census records all give Alabama as Samantha's place of birth. It is clear that the Fowlers came into Alabama via the Federal Road, but we have no indication of where Richard Fowler settled between 1819 and 1821. On 19 October 1821, Richard Fowler "*of Monroe County*" purchased land at the Cahaba, Alabama Land Office (Cahaba, Alabama Cash Entry #470).
6. Fowler's land in Section 20, Township 8 North, Range 5 East lay just about 1.5 miles due west of the Alabama River, which is the border between Clarke and Monroe Counties. Since that transaction gave his residence as Monroe County, he had presumably resided on land there before this purchase (Cahaba, Alabama Land Office Cash Entry #470). Fowler purchased 80.1 acres for \$100.12½.
7. Cahaba, Alabama Land Office Cash Entry #3314.
8. Cahaba, Alabama Land Office Cash Entries #3314 and 7571. These records are abstracted above. On 22 July 1828, Martin Batte Lee purchased the W½ of SW¼ of Section 31, Township 13, Range 11 in Dallas County, the property that lay along the western side of Fowler's new farm (Cahaba, Alabama Cash Entry #3600). Since Fowler owned this 80-acre tract in 1833, he must have purchased it from Lee between 1828 and 1832. This conveyance was not recorded in either Dallas or Wilcox Counties.
9. Dallas County AL Deed Book C, pp. 365–366. Fowler paid a total of \$189.44 for the 160 acres he purchased from the government. We do not know what he paid Lee for the remaining 80 acres, but Lee paid the government exactly what Fowler did (\$100.06).
10. Enoch Albritton of Wilcox County, Alabama purchased this 141.8 acres at the Cahaba, Alabama Land Office on 25 May 1831: SW¼ of Section 4, Township 12 North, Range 11 East (Cahaba, Alabama Land Office Cash Entry #7947). Albritton claimed the right of "*Preemption*," meaning that he had settled the vacant land, cleared acreage for agriculture, and established residence on it before the government offered the land for sale to the public. This gave him the right to purchase it before anyone else. Enoch Albritton and his wife, Penelope Frizzle, sold it to William Drake on 2 October 1833 (Wilcox County AL Deed Book C, p. 93). Richard Fowler presumably purchased this property from William Drake sometime between October 1833 and 16 August 1837 (Wilcox County AL Deed Book

E, pp. 151–152). The transaction from Drake to Fowler was not recorded in Wilcox County, so we do not know exactly when it occurred.

11. Wilcox County AL Deed Book E, pp. 151–152 shows that by 16 August 1837, Richard Fowler had purchased two additional tracts of land: SW $\frac{1}{4}$ of NW $\frac{1}{4}$ and SE $\frac{1}{4}$ of NW $\frac{1}{4}$ of Section 4, Township 12 North, Range 11 East. The SW $\frac{1}{4}$ of NW $\frac{1}{4}$ was purchased from the government by David Seale on 27 November 1833 (Cahaba Cash Entry #17889), and the SE $\frac{1}{4}$ of NW $\frac{1}{4}$ John W. Campbell on 28 January 1834 (Cahaba Cash Entry #17889). The transactions in which Fowler purchased these tracts were not recorded in Wilcox County, but they must have occurred between 1834 and 1837.
12. Richard Fowler's second farm lay in Sections 16 and 17, Township 12 North Range 11 East, a location just two miles due south of his existing farm near the Wilcox/Dallas county line that adjoined Addison Scarborough's farm. On 24 November 1840, Fowler purchased the SE $\frac{1}{4}$ of SE $\frac{1}{4}$ (except ten acres) of Section 17 (Wilcox County AL Deed Book J, p. 594–595). On 15 May 1843, he purchased the NE $\frac{1}{4}$ of SE $\frac{1}{4}$ of Section 17 (Wilcox County AL Deed Book G, p. 525), and on 22 August 1844, Fowler bought the NW $\frac{1}{4}$ of SW $\frac{1}{4}$, Section 16 (Wilcox County AL Deed Book J, pp. 589–590). There is no record of his obtaining the remainder of his second farm, as those transactions were not recorded. Proof that he owned these additional tracts comes from when Richard and Sarah Fowler sold the property on 13 November 1850 (Wilcox County AL Deed Book J, pp. 593–594). The Fowlers' second farm consisted of a total of 147 acres. They also must have purchased the SW $\frac{1}{4}$ of SW $\frac{1}{4}$ of Section 16 from Silas W. A. Albritton, who bought it from the local government on 21 December 1844 (Section 16 was exclusively reserved for the use of the local schools, so the government transferred it to Wilcox County, and then the county sold whatever portions remained after schools were established). It remains unclear why Richard and Sarah Fowler purchased this second farm. It could have been an investment, or perhaps the family of one or both of their married daughters operated it (Milly Fowler Albritton or Samantha Fowler Scarborough). It appears that the Fowler's primary residence and farm was the one closer to the county line, as it was the most valuable property based upon the sales prices of their two farms when they sold them both in November 1850.
13. 1830 Dallas County AL Federal Census, p. 76, line 2. 1840 Wilcox County AL Federal Census, p. 326, line 24.
14. Union Parish LA Police Jury Minutes Book 1852–1869, p. 41. This record contains this entry:
"Jas. Perdue overseer on the road leading to Van Hooks old Bridge commencing at the Forts of the road below David Ward's and work to the Deluter [sic] and have the following hands subject to him for 1 year...Fowler's 2 Hands..."
 The term "hands" in these early records refers to either a man's teenaged, minor sons or his slaves. Since Fowler's only son married in 1847 and does not appear to have followed him to Union Parish, Louisiana, this reference must be to Fowler's two slaves.
15. Union Parish LA Conveyance Book G, pp. 172–173. Prince's fate after his 1855 purchase by Fowler remains unclear. Of Fowler's known four sons-in-law, only three owned slaves in 1860: George W. Albritton (nine slaves), James R. Albritton (one slave), and Wiley J. Polk (twelve slaves). Prince would have been 50 years of age by 1860, and none of them own a slave near that age. Each of them owned only one adult male slave: James R. Albritton's was aged 37, George W. Albritton's was aged 32, and Polk's was aged 60.
16. Bethlehem Baptist Association Minutes, 1831–1836. 1831–1976 History of Bethsaida Baptist Church comes from a printed church program.
17. Wilcox County AL Deed Book M, p. 512. This record shows Martin B. Lee and James Griffin as deacons of Bethsaida Church, and Addison Scarborough as an ardent supporter of the church. 1838–1847 Ebenezer Primitive Baptist Association Minutes, Samford University Library, Birmingham, Alabama show Scarborough as a member of Bethsaida Church. Union Parish LA Conveyance Record H, pp. 456–457 shows James D. Griffin owning a farm in Union Parish, Louisiana that adjoined Richard Fowlers. James D. Griffin is known to have moved to Louisiana from Snow Hill, and he is believed to be the son of the older James Griffin who was a deacon at Bethsaida.
18. Dallas County AL Deed Book C, pp. 365–366 (17 Jan 1833, Richard and Sarah Fowler to Henry McCoghren; signed by Richard, with Sarah making her mark to the document). Columbus County NC Deed Book F, pp. 36–37 (17 Oct 1835; signed by Richard Fowler). Wilcox County AL Deed Book E, pp. 151–152 (July 26 and Aug 16, 1837; signed twice by Richard Fowler). Wilcox County AL Will Book 1 (1826–1844), p. 316–318 (will of Peter Lee, 24 September 1838; signed by Richard Fowler); Will Book 2, p. 166 (Richard Fowler's guardian's bond, 26 October 1844; signed by Richard Fowler). Wilcox County AL Deed Book J, pp. 588–594 (13 Nov 1850; three transactions all signed by Richard Fowler, with Sarah Fowler making her mark to all three). Union Parish LA Conveyance Book D, pp. 527–529 (17 Oct 1851; signed by Richard Fowler). United States Bounty Land Application of Richard Fowler, United States National Archives (shows Richard Fowler's original signature at age sixty). Fowler's 1838 original signature comes from the original copy of Peter Lee's 1838 will, filmed by the LDS as Wilcox County, Alabama Probate Court, Estate Case Files Loose (image #1898–1900).
19. Union Parish LA Succession Book H-1, pp. 123–125 (25 Mar 1851; Elvira Fowler Polk made her mark to the document appointing her as the "Natural Tutrix" of her minor children). Union Parish LA Conveyance Book U, p.

- 246 (25 Jan 1884; Samantha Fowler Scarborough makes her mark to the document). Union Parish LA Conveyance Book Z, p. 291 (25 Feb 1891; Samantha Fowler Scarborough makes her mark to the document). Union Parish LA Conveyance Book 9, pp. 248–250 (18 July 1901; Samantha Fowler Scarborough makes her mark to the document). Monroe, Louisiana Land Office Homestead Application #92 (26 Nov 1872; Sarah Ann Albritton made her mark to the document). The following census records list the indicated Fowler daughter as a person who cannot read or write: 1850 Clarke County AL Federal Census, Population Schedule, p. 231, Household #385 (Elvira). 1860 Union Parish LA Federal Census, Population Schedule, p. 118, Households #754 (Sarah Ann) and #755 (Samantha). Many upper-middle class white Southern farmers of this era educated their sons but not their daughters. For example, the five sons of James Seale (1769–1860) all received an education, with one (James H. Seale) becoming an attorney and serving as the sheriff of Union Parish, Louisiana and Clerk of Court of Jackson Parish. However, Seale's daughters all remained illiterate throughout their adult lives (Mary Seale Bates, Matilda Seale Parmer Grant, Clarendia Seale Ham, Cynthia Seale Ward, and Elvira Seale Cooper).
20. Texas Confederate Pension Application of J. R. Albritton, Navarro County, Texas, approved 27 Jan 1900. Susan signed an affidavit on 23 August 1899 in which she stated, in reference to her husband, that *"I went to school with him when I was twelve years old..."* and that she has *"...been acquainted ever since we was children in Alabama near Snow Hill, in Wilcox County..."* United States laws reserved Section 16 for the use of local schools. Richard Fowler bought a second farm near the Village of Snow Hill (what is currently *"Old Snow Hill"*) in the latter 1830s, with half of this farm laying in Section 16. From the Federal Tract Book records of Township 12 North, Range 11 East showing Snow Hill and the surrounding region, including Richard Fowler's farms, the local government began selling off Section 16 in 1840 and 1841, indicating that they had by then formed schools and were then disposing of the remaining portions.
 21. *The Georgia Genealogical Magazine*, No. 34, October 1969, p. 2343. Penelope Yelvington and son Moses C. Yelvington of Talbot County Georgia wrote these letters to her son (and Moses' brother) Robert J. Yelvington of Greenwood, Louisiana. *"Macon Weekly Telegraph,"* 24 February 1846. This paper mentions the severe drought in Georgia during the summer of 1845.
 22. Louisiana Confederate Pension Application #8239, Samantha E. Ham (widow of Hillory H. Ham), Union Parish, filed 8 December 1909 and 1 September 1920. Louisiana Confederate Pension Application #13385, Susan Malissa Scarborough (widow of George N. Scarborough), Union Parish, filed November 24, allowed December 11, 1928. Both Samantha Elvyann and Susan Malissa Scarborough are granddaughters of Richard and Sarah Fowler, their being daughters of Samantha Fowler Scarborough. Both stated in their applications that they had resided in the state of Louisiana since the year 1847. Ouachita, Louisiana Land Office Cash Entries #9304 (22 Feb 1848, Noah Scarborough) and #10018 (12 July 1849, George W. Albritton). Ouachita, Louisiana Military Warrant #54487 (25 Sept 1849, Martin B. Lee, assignee). This documentation verifies the 1847 arrival in Union Parish, Louisiana of Samantha Fowler and her family. It appears that Albritton and the Lees came with the Scarborougs, but if not, they followed them the next year.
 23. Louisiana Confederate Pension Application #7156, E. R. Albritton, Union Parish, filed 12 April 1911. Albritton stated that he had lived in Louisiana *"since I was seven years old."* Since he was born in June 1843, this indicates that he did not arrive in Louisiana until 1850. Since we know that Samantha Fowler Scarborough's children went to Louisiana with their parents in 1847, this would suggest that Milly Fowler died in 1846–1847, following the birth of her second son, and the boys remained in Snow Hill with either her parents, Richard and Sarah Fowler, or their paternal grandmother, Penelope Frizzle Albritton, while their father went to Louisiana. George W. Albritton returned to Snow Hill during the winter of 1849–1850, married his first wife's younger sister, Sarah Ann Fowler, on 3 January 1850 in Wilcox County, Alabama, and then took his new wife and two sons to their new home in Union Parish, Louisiana.
 24. 1850 Wilcox County AL State Census, Image #1, p. 1, line #12: R. Fowler; Image #25, p. 1, line #12: Richard Fowler.
 25. Wilcox County AL Deed Book J, pp. 588–594. The Fowlers sold 106.35 acres of their primary farm near the Dallas County line to William M. Purifoy and the remaining 106.35 acres to Francis M. Purifoy. They sold their 147-acre farm near Snow Hill and the Bethsaida Baptist Church to Edmund Hobdy.
 26. Richard and Sarah Fowler sold their farm in three separate transactions dated 13 November 1850. The census enumerator visited their neighbors at Snow Hill on November 15, and he did not include the Fowlers as residents. This suggests that they had already left Snow Hill by the 15th.
 27. Wilcox County AL Probate Record Book 7, p. 227. Union Parish LA Succession Book H-1, pp. 123–125. Elvira Fowler Polk's husband, Wiley J. Polk, presented his final account as guardian of Elvira's children by her first husband to the Wilcox County, Alabama Probate Court on 5 December 1850; this indicates their imminent emigrate from Alabama. On 22 March 1851, Elvira petitioned the Union Parish Court, stating that
She has lately removed from the State of Alabama to your said Parish bringing with her three minor children Sarah A. E., John R., and Roan A. Robinson the...sole surviving issue between Elvira Polk and Amos Robinson late of the State of Alabama and County of Clark dec'd.

It is not known if Richard and Sarah Fowler came directly to Union Parish, Louisiana immediately after selling their Snow Hill farms, or if they waited and made the journey with Elvira and her family between December 1850 and March 1851.

28. Union Parish LA Conveyance Record D, p. 527. Johnson Malone sold Richard Fowler 237.39 acres of land including the NE $\frac{1}{4}$ and NE $\frac{1}{4}$ of SE $\frac{1}{4}$ of Section 18, the SW $\frac{1}{4}$ of NW $\frac{1}{4}$ of Section 17, Township 21 North, Range 2 East.
29. Monroe, Louisiana Land Office Cash Entries #12217 (22 Nov 1852), #14143 (15 Nov 1854), #17597 (10 Oct 1857), #17743 (3 Dec 1857), #21063 and 21066 (27 Oct 1859), all for Noah Scarborough.
30. United States Bounty Land Application of Richard Fowler, United States National Archives.
31. Union Parish LA Conveyance Record G, pp. 172–173.
32. Monroe, Louisiana Land Office Cash Entry #17744, 3 December 1857, to George W. Albritton.
33. Union Parish LA Conveyance Record H, pp. 456–457. James D. Griffin is believed to be the son of James Griffin, the deacon of Bethsaida Primitive Baptist Church at Snow Hill; see Wilcox County AL Deed Book M, p. 512.
34. Monroe, Louisiana Land Office Cash Entry #19759 to George W. Albritton. This document required Albritton to state the precise description of his existing farm. Albritton listed his existing farm as the property Richard Fowler purchased in 1851. There is no recorded document in Union Parish, Louisiana by which Albritton acquires Richard Fowler's farm. The transaction must have not been recorded.
35. Union Parish LA Federal Census, Mortality Schedule, p. 3/497, line #27.

◆ ◆ ◆ ◆ ◆ ◆